

LEGEND

LETTERS OF THE ALPHABET USED IN THIS ATLAS TO DESIGNATE SMALL TRACT OWNERS ARE NOT OFFICIAL GOVERNMENT LOT DESIGNATIONS

- TRUNK HIGHWAY
- COUNTY ROAD
- TOWNSHIP ROAD
- RAILROAD
- TIE-IN MARKERS
- CITY & VILLAGE LIMITS
- PLATTED AREA
- CREEKS & COULEES
- OPEN DITCH
- TILE DITCH

- RIVER AND OTHERS AND WIFE
- FARM BUILDINGS
- MEANDERED WATER LINE & GOVERNMENT LOT DESIGNATION
- SCHOOL
- CHURCH
- CEMETERY
- TOWNHALL



THE SMALL PRINTED NUMBERS TO BE FOUND ALONG SIDE THE FARM BUILDINGS, IS THE LAST NUMBER IN THE FARM CODE - THE EXPLANATION OF THE CODE IS IN THE HEADING OF THE RURAL DIRECTORY.

MAP INDEX

PAGE NUMBER OF TOWNSHIPS ARE LISTED BELOW TOWNSHIP NAME - CODE LETTER OF TOWNSHIP ARE LISTED BESIDE THE PAGE NUMBER.

BROOKING COUNTY		MINNESOTA COUNTY	
<p>FREMONT 8-S</p>	<p>RIVERVIEW 13-N</p>	<p>SPRING CREEK 14-HR</p>	<p>WARD WARD ● 16-X</p>
<p>JEFFERSON 10-NY</p>	<p>CLARE 3-Y</p>	<p>FLANDREAU 7-E ● FLANDREAU</p>	<p>UNION 15-L</p>
<p>COLMAN ● COLMAN 4-R</p>	<p>EGAN ● LONG TREE 5-EL</p>	<p>● EGAN GROVENA 9-XA</p>	<p>LONE ROCK 11-W</p>
<p>LYNN 12-LY</p>	<p>ENTERPRISE ● TRENT 6-U</p>	<p>BLINSMON 2-H</p>	<p>ALLIANCE 1-A</p>

ALLIANCE

TOWNSHIP 105 N.

RANGE

CODE LETTER A

LONE ROCK

TWP.

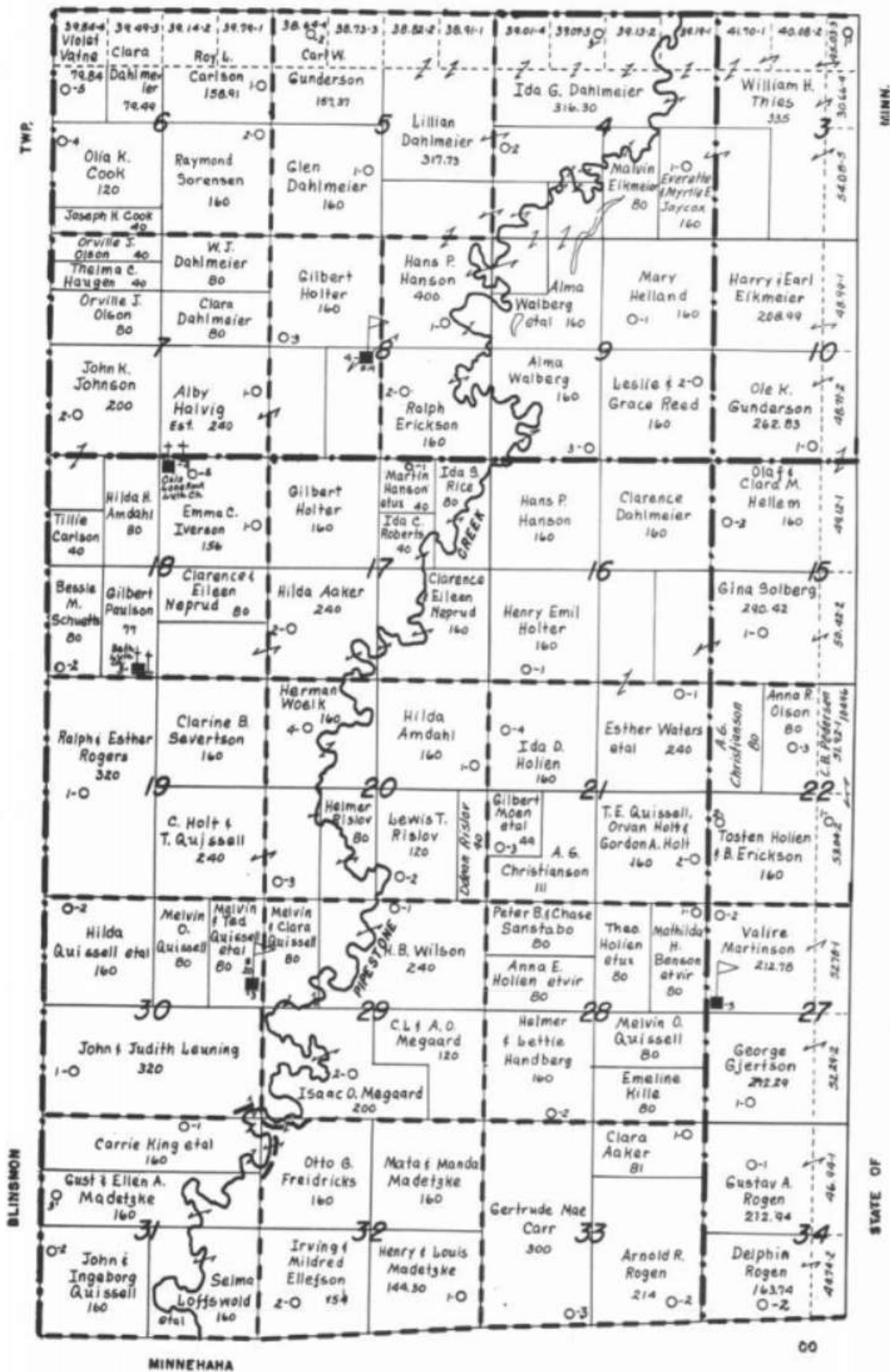

BLINSMON

TOWNSHIP 105 N.

RANGE 48 W.

CODE LETTER H

GROVENA

TWP.

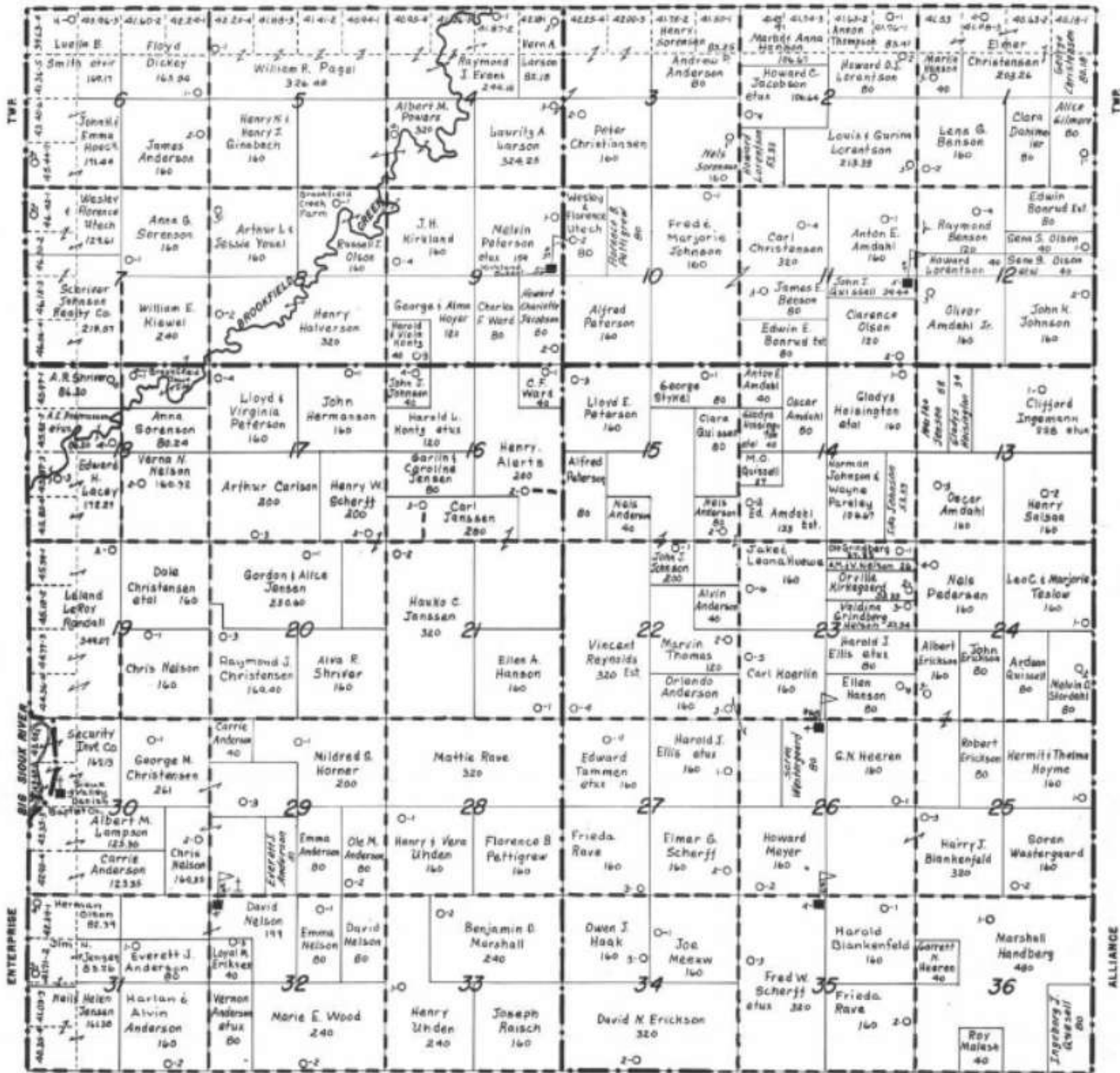

MINNEHAHA

60.

CLARE

TOWNSHIP 107 N.

RANGE 49 W.

CODE LETTER Y

RIVERVIEW

TWR

TWR

TWR

JEFFERSON

FLANDREAU

ESAN

TWR

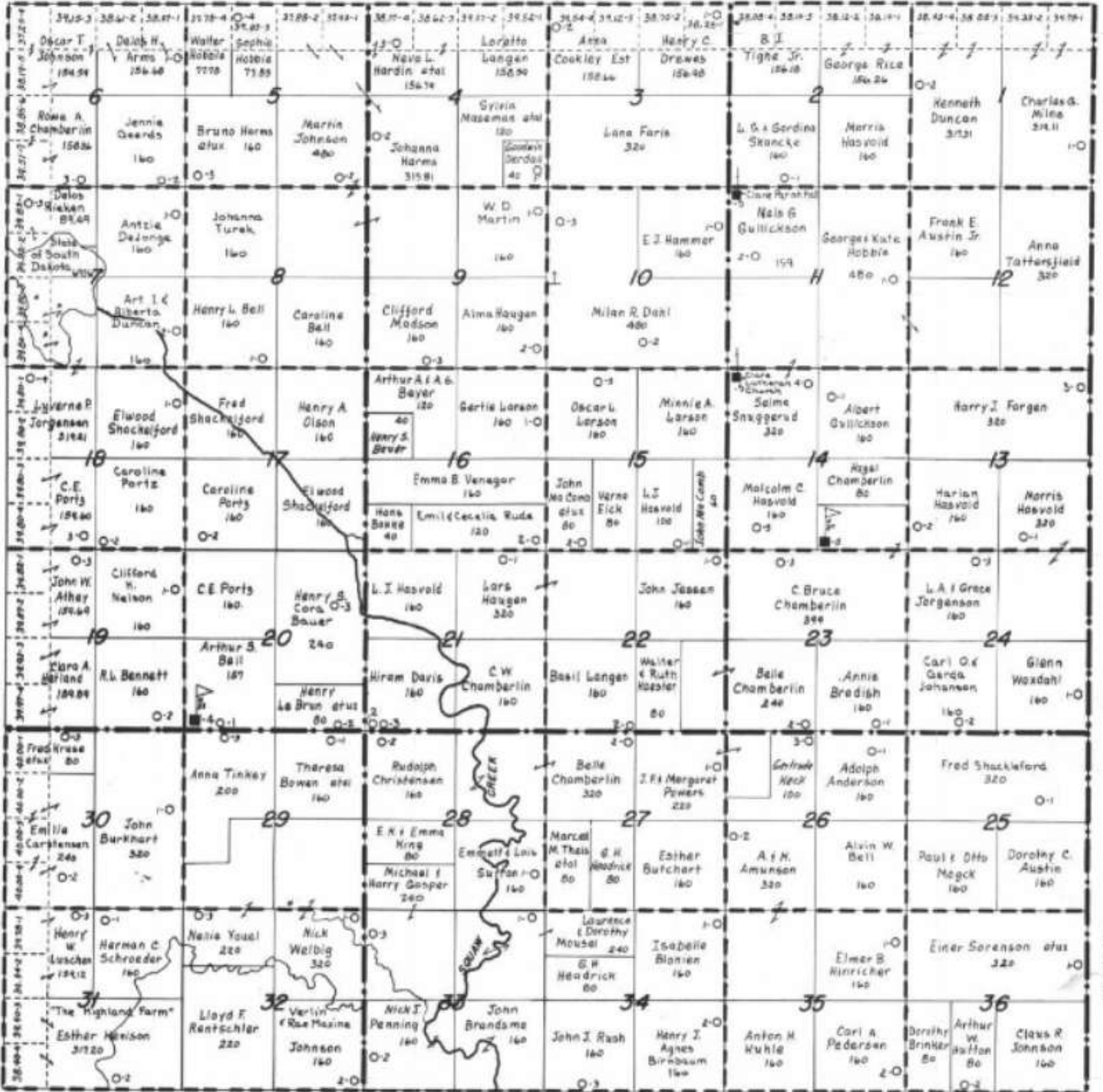

EGAN

TOWNSHIP 106 N.

RANGE 49 W.

CODE LETTER EL

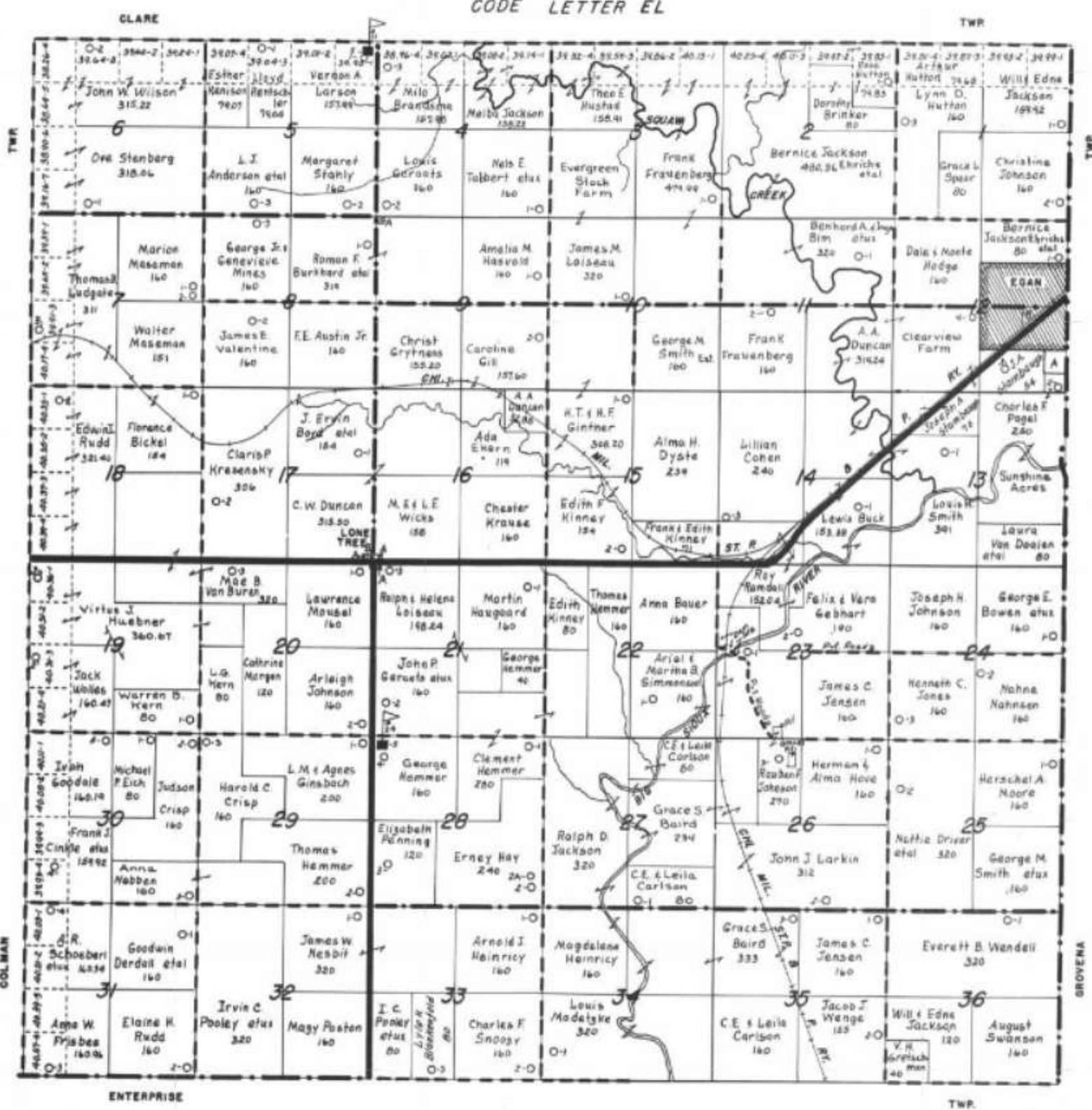

SMALL TRACT OWNERS

TRACT	OWNER	ACRES
9 A	East River Elec Power Co	1.00
12 A	Alvina Schröder	15.00
12 B	Ch. M. & P. R. Ry.	6.75
13 A	Meady Co.	—
14 A	Su Valley Empire Elec.	2.00
17 A	Esther Bowen	1.50
17 B	Robert J. Fjar	2.20
21 A	Esther Bowen	1.00

ENTERPRISE

TOWNSHIP 105 N.

RANGE 49 W.

CODE LETTER U

EGAN

TWP

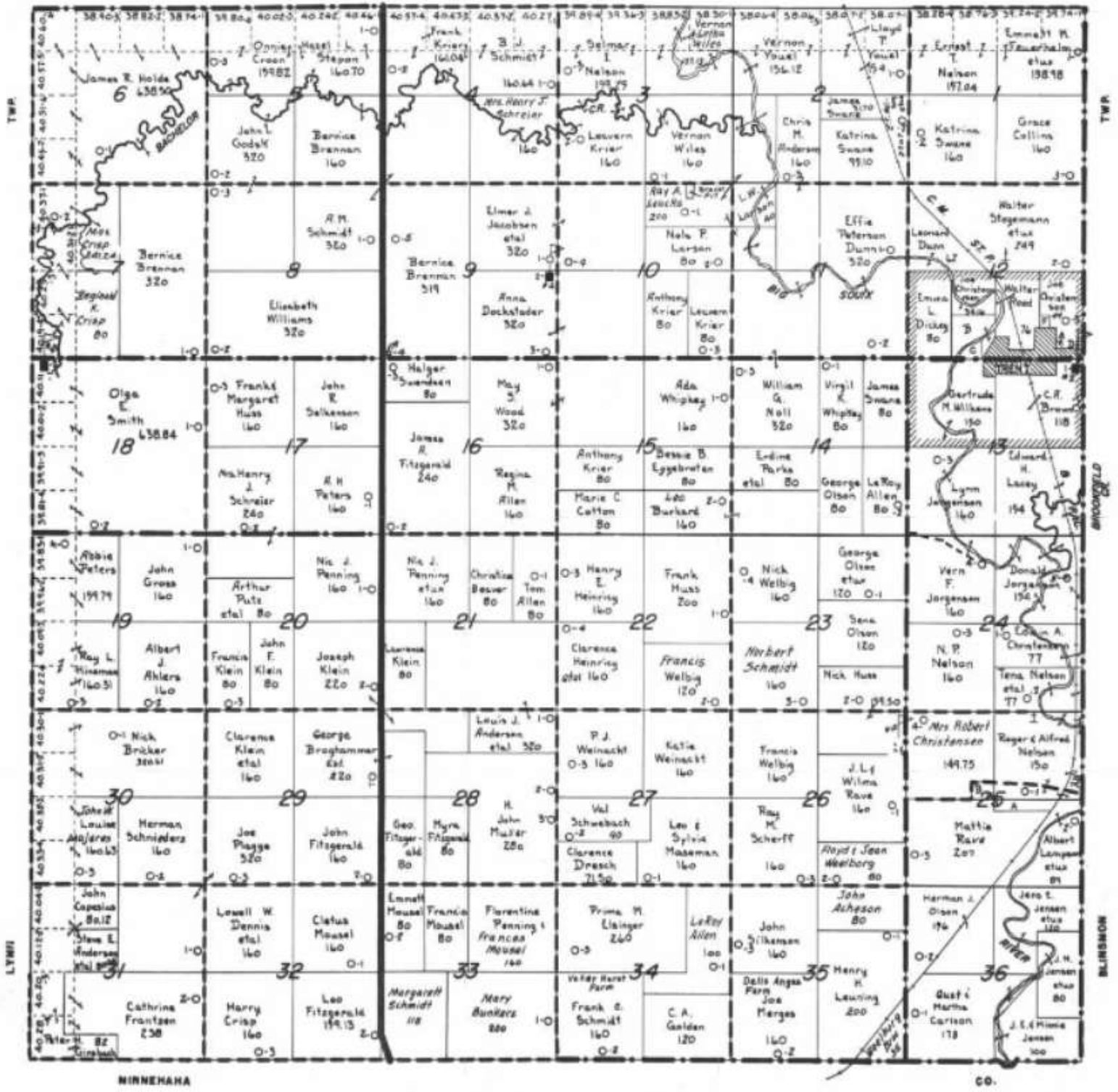

SMALL TRACT OWNERS

SEC TRACT	OWNER	ACRES
1	Walter J. Bahl	100
2	Trust Com. Assn Inc	400
3	Gertrude M. Wilkins	100
4	Evelyn Schuman	100
12	Walter Reed et al	135
17	Trust of Trust	100
29	Roger J. Nelson	2317
29	Alfred C. Nelson	933

FLANDREAU

TOWNSHIP 107 N.

RANGE 48 W.

CODE LETTER E

SPRING CREEK

TWP

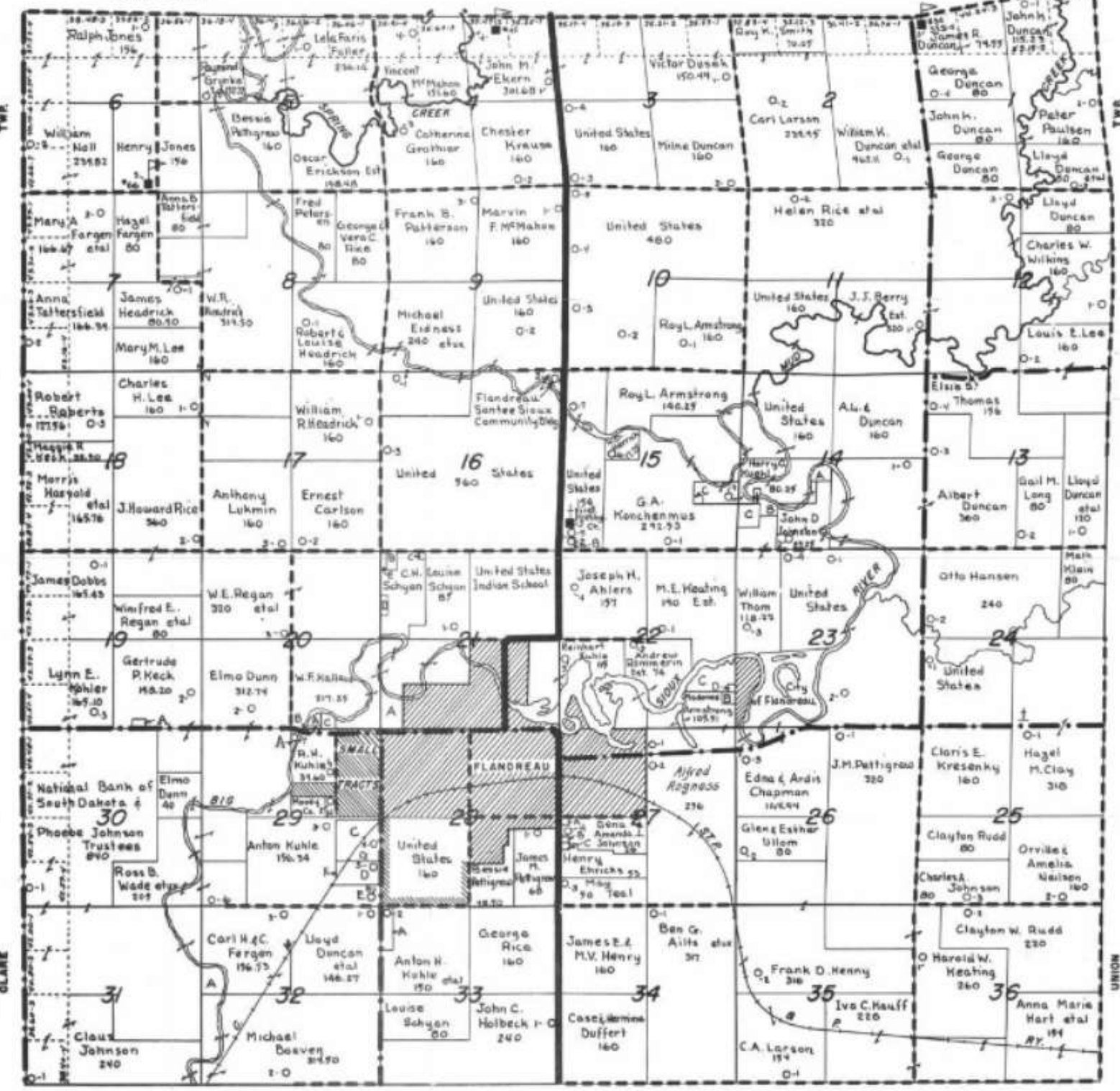

GROVENA

SMALL TRACT OWNERS

TWP

SEC TRACT	ACRES	SEC TRACT	ACRES	SEC TRACT	ACRES	SEC TRACT	ACRES
14 A Meedy County	15.00	20 A R.H. Kuhle	15.47	22 B Veterans of Foreign Wars	2.00	21 E Fred Kappelman et al	19.00
14 B Oscar Ostby	15.00	20 B S.P. Kuhle	1.47	22 C Clinton Getchar	15.00	21 F Lewis H. Heskins	7.40
14 C United States	15.00	20 C Gaylord Price	3.00	22 D City of Flandreau	15.00	21 G Nora Daniels	11.90
15 B Alma Handberg	4.40	21 A Walter A. & Belle Frohneider	3.00	23 A Lewis H. Heskins	10.00	21 H Henry Mann	4.00
15 C Meedy County	3.80	21 B Lettie Myreau	3.12	23 B M.E. Russell et al	7.40	21 I Fred & Nora Kruse	10.00
16 A United States	240	21 C Robert Heschane	1.00	23 C A.L. Storer et al	22.00	21 J Meedy County	10.00
		21 D Samuel Walls	4.40	24 A John Lange	20.00	21 K Ralph & Mardella Cook	1.00
		21 E I.E. Locke	2.40			21 L Harry Halverson	1.00
						21 M Vasilie Stephenson	1.00

FREMONT

TOWNSHIP 108 N.

RANGE 50 W.

CODE LETTER S

BROOKINGS

CO.

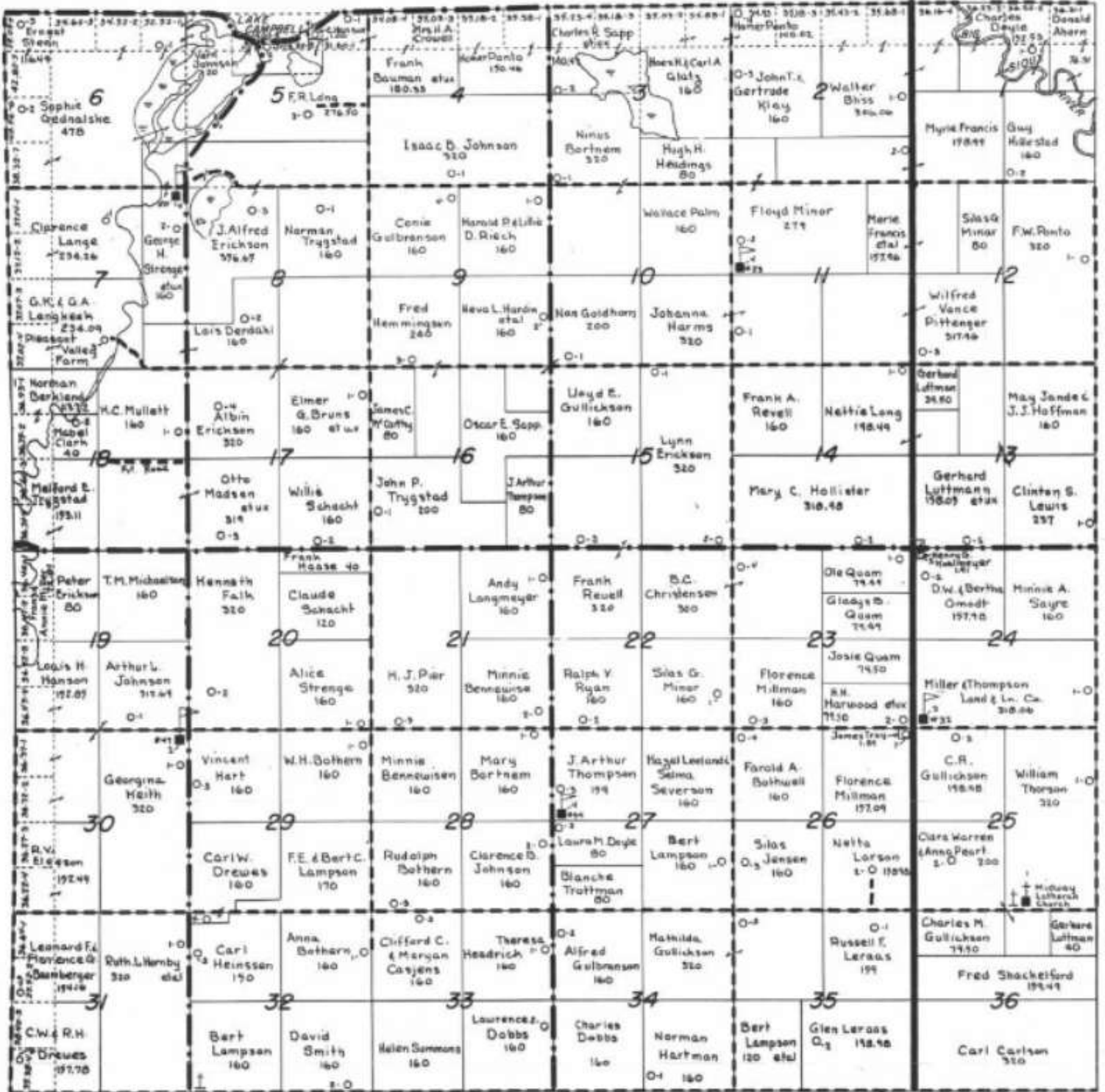

JEFFERSON

TWR

TWR

RIVERVIEW

GROVENA

TOWNSHIP 106 N.

RANGE 48 W.

CODE LETTER XA

FLANDREAU

TWP.

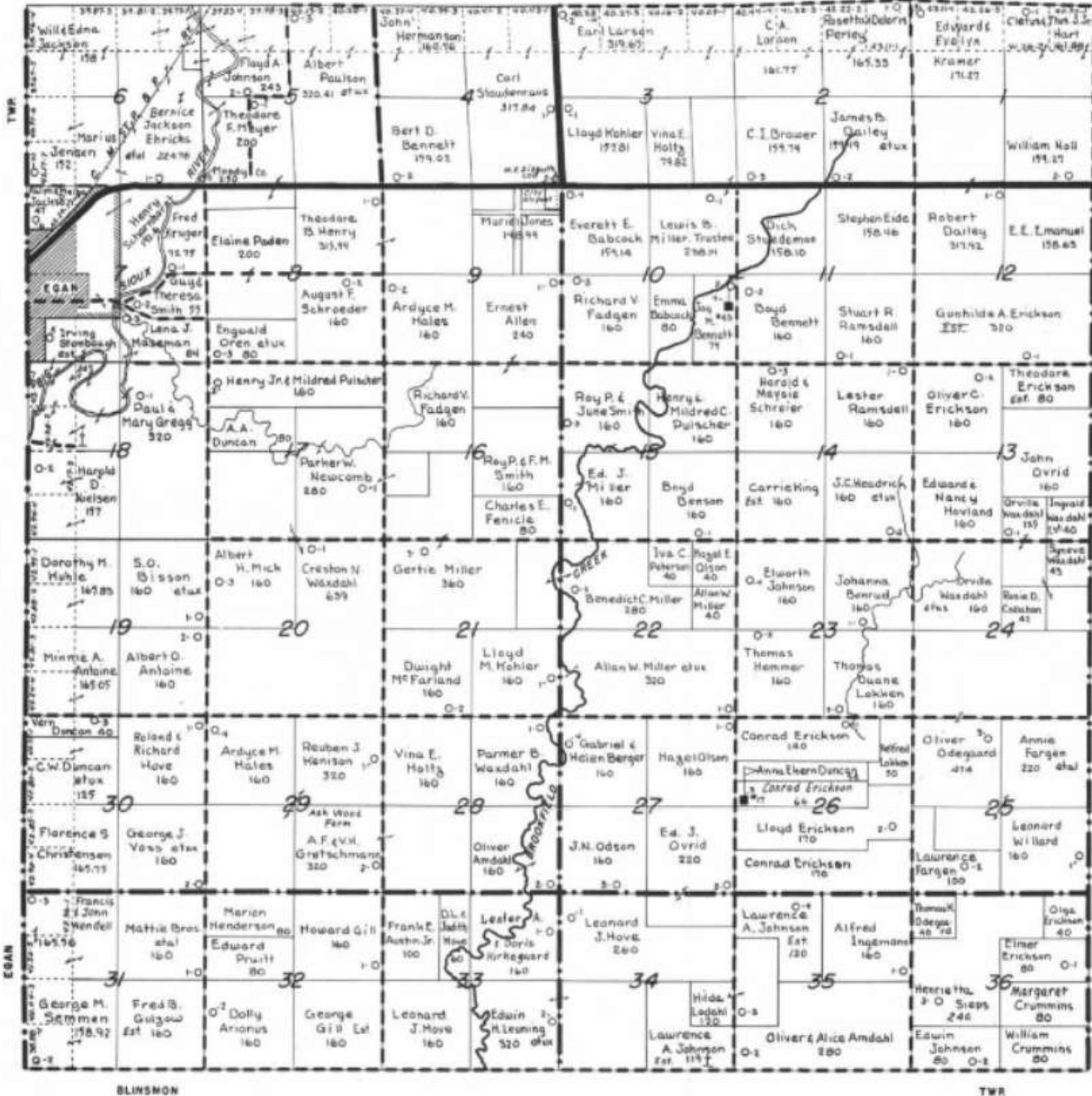

BLINSSON

TWP.

ESAN

JEFFERSON

TOWNSHIP 107 N.

RANGE 50 W.

CODE LETTER NY

FREMONT

TWR

3885-1 Vera WBRK 152.00	3900-2 William L. Wellman 159.52	3920-4 Henry R. Schocker 319.52	4020-2 David Smith 160.21	4020-4 Alfred Gulbranson et ux 160.21	4020-6 Harry Larimore 320.01	4020-8 William M. Specht 160.14	4020-10 Norman Hartman 160.29	4020-12 Carl Larson 315	4020-14 Walter C.T. Nelson 31.00	4020-16 Carl Carlson 154.49	4020-18 Harry A. Olson et ux 155.92	4020-20 Oscar T. Johnson 152.80
Clouda Krach 152.52	E.F. Messner & Mabel George 160	Clouda Krach 160	Fannie Anderson et ux 160	Margaret Dobbs 160	Orland Bakke dahl 160	Berry A. Olson 34	M.A. Paterson 200	Dorothy Brinker et ux 160	Rose A. Chamberlin 160			
Sulks G. Lee 303.71	Clouda & Myrtle Krach 160	R.E. Sandager et ux 157.60	Bessie Pellegrew 202.40	Vincent Dobbs et ux 320	Leo Walbig 160	Glenn Ada Bothwell 160	Dorothy Brinker 50	Rose Kutton et ux 320	Dorothy Brinker 160			
	Albert & Betty Talkamp 320	Ruth H. Achason 120	Clouda Krach 160	William J. Moore 160	Marvin Edith Pickard 160	Mayma B. Leahr 160	Mrs. Harry Larimore 160	E.W. & Gladys Johnson 160	Anton N. Jensen 320			
Floyd Lee 312.85	Clouda E. Krach 80	Mabel C. Vaughn et ux 160	A.W. Tostes 160	John H. Reaves 160	Adah F. Reaves 320	Dorothy Brinker 320	Robert Frank Bothwell 229	William Anderson 153.18	J. Panga & T. Anderson 160			
Race Lewis 158.65	F.R. & Doris Lee 160	F.R. Lee et ux 105	Kagel E. Christensen 214	Arthur W. Tostes 160	M.F. & J.B. Nelson 160	Annie Nelson 160	Raleigh W. Bothwell 320					
William Z. Tostes 320	Virgil E. Merrill et ux 160	Henry A. Olson et ux 160	Ernest A. Booth 480	C.D. & Beattie Youel 160	M.A. & Josie Paterson 160	Michael A. Peterson 160	Wendell H. Johnson 320					
Carrie DeYork 152.04	Lewis Lewis 160	M.D. Lewis 320	Clifford C. Hanson 160	Olag Barinam 160	J.H. & Emma Noeck 160	R.C. & Sasie Entringer 320	Cyrus W. Whaley 160	Benjamin F. Elhoff 160	C.W. Whaley 320			
Oscar Espeland 202.52	Clarence W. Anderson 160	Edith Hebnar 160	Charlie Hainsan et ux 160	Iva M. Benson 160	Clarence W. Anderson 160	L.H. Hubner 160	Henry & Nellie Kroon 80	C.D. Youel 160	Beattie A. Youel 320			
Dorothy Wangberg 150	Wallace R. Bothwell 59	Martha E. Olson 240	William C. Walbig 160	Clays L. Rush 160	Peter Wartenhorst 320	F.C. Nilsson et ux 160	Earl King et ux 160	Odd Hoops et ux 240	Marie J. Davies 160			
KRILL Eilens 152.56	Peder B. & L. Senan 160	John Espiland 80	Albert N. Wayne 80	Will Noleboom 160	Lloyd A. Parker et ux 320	Frank N. Peak 160	John E. Gueffroy 160	Thos. Thompson 80	John W. Wilson 80			
Robert F. Ashby 254.52	William N. Thoup 80	Palmer Kringsen et ux 160	H.M. Lee 640	Chris M. Jensen 320	George N. Smith 160	Thos. Thompson et ux 320						

TWR

CLARE

COLMAN

TWR

LONE ROCK

TOWNSHIP 106 N.

RANGE

CODE LETTER W

UNION

TWR

Moody Co. 150

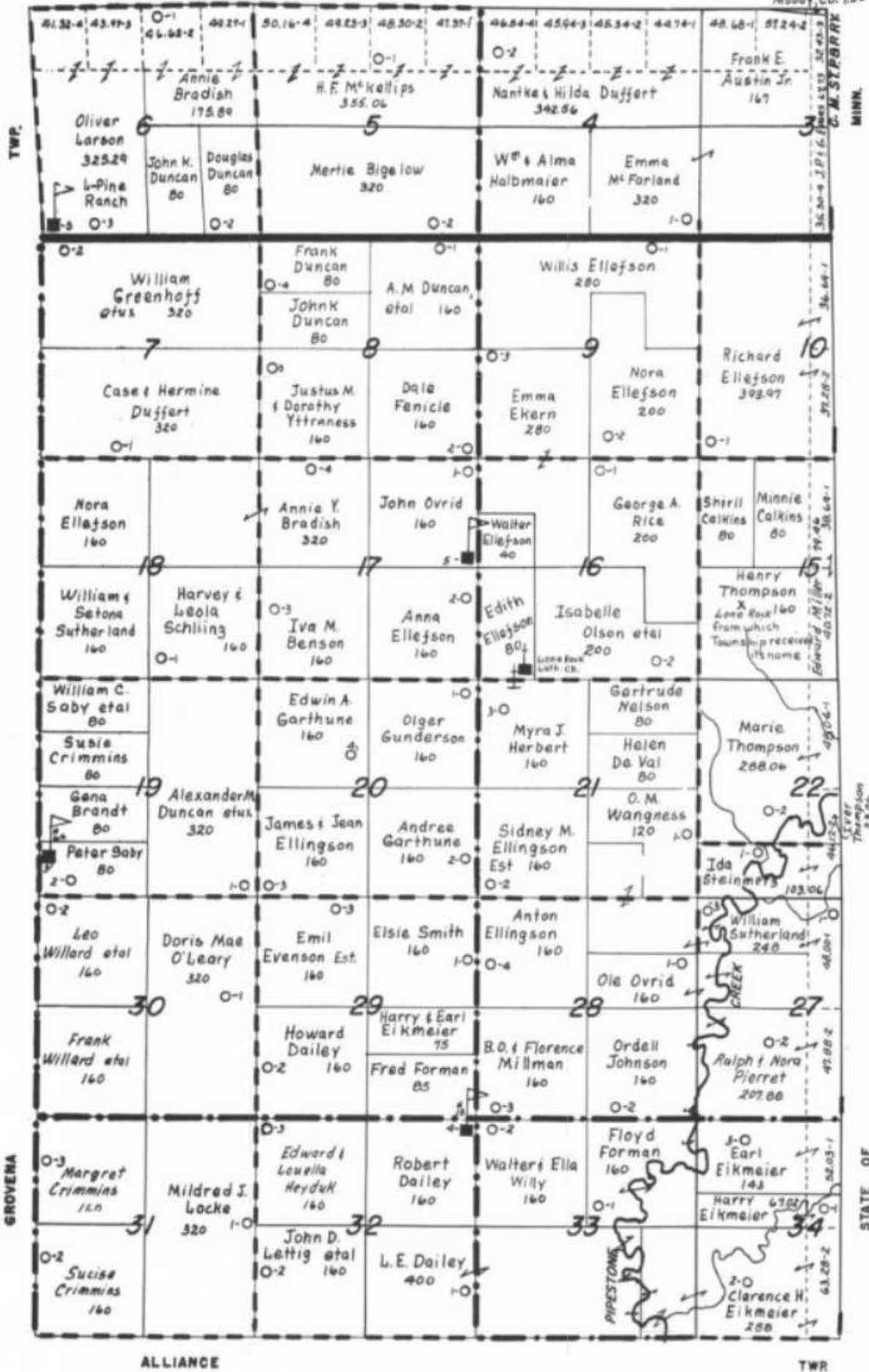

LYNN

TOWNSHIP 105 N.

RANGE 50 W

CODE LETTER LY

COLMAN

TWP.

CO.

TWP.

LAKE

ENTERPRISE

MINNEHAHA

CO.



LYNN

TOWNSHIP 105 N.

RANGE 50 W

CODE LETTER LY

COLMAN

TWP.

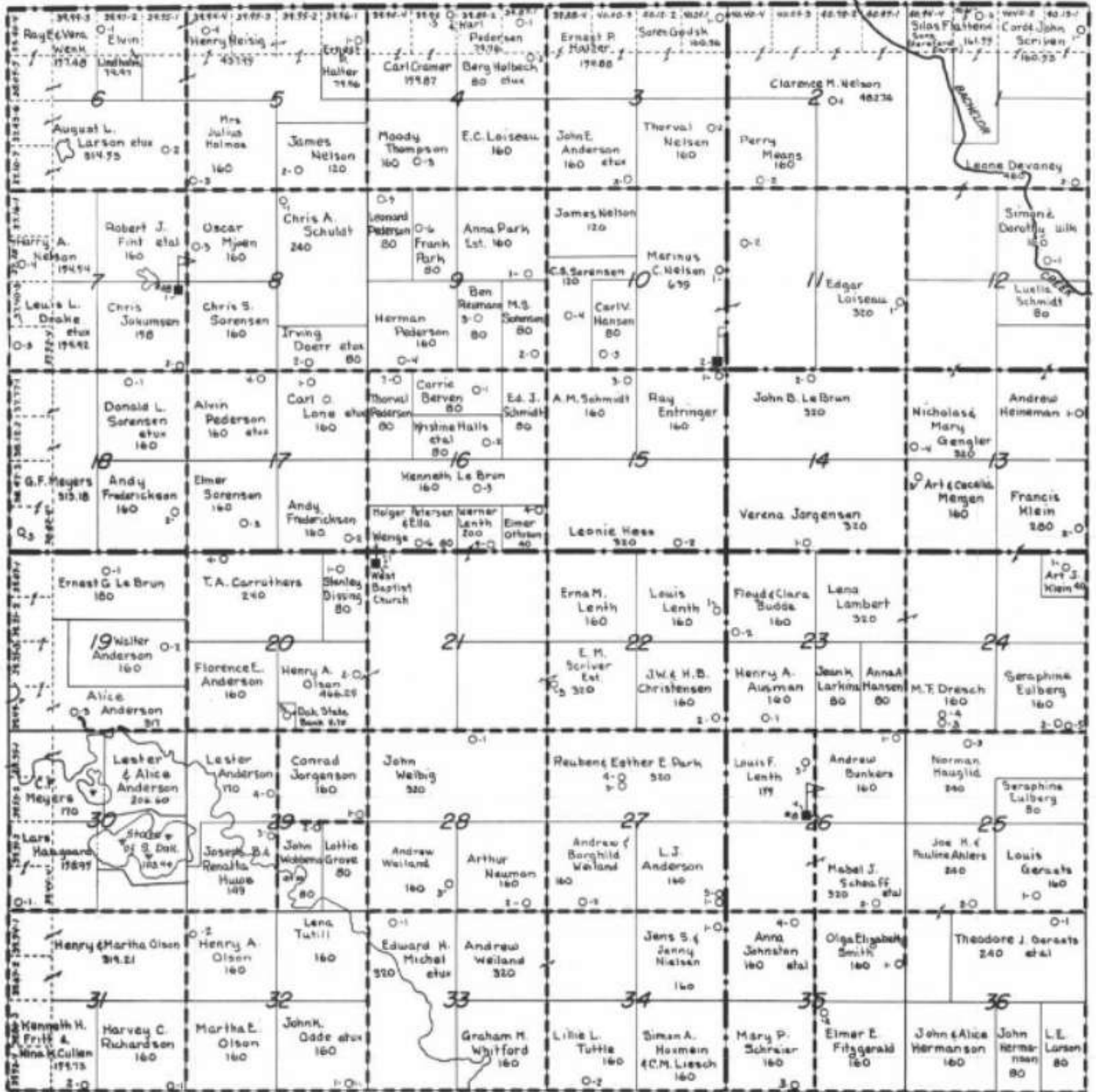

MINNEHAHA

CO.

CO.

TWP.

LAKE

ENTERPRISE

UNION

TOWNSHIP 107 N.

CODE LETTER L

RANG

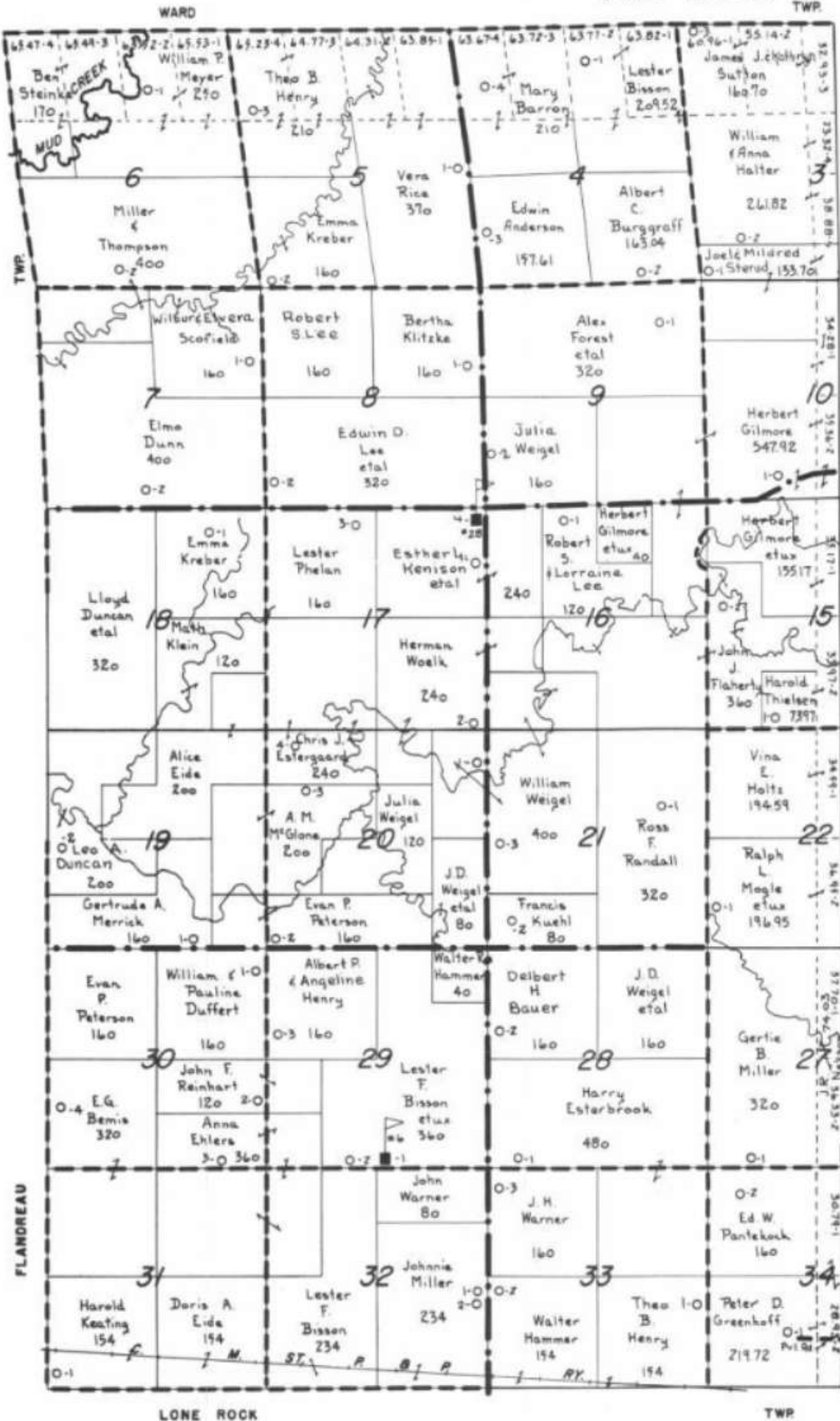

LONE ROCK

TWP

WARD

TOWNSHIP 108 N.

RANGE 47 W.

CODE LETTER X

BROOKINGS

CO.

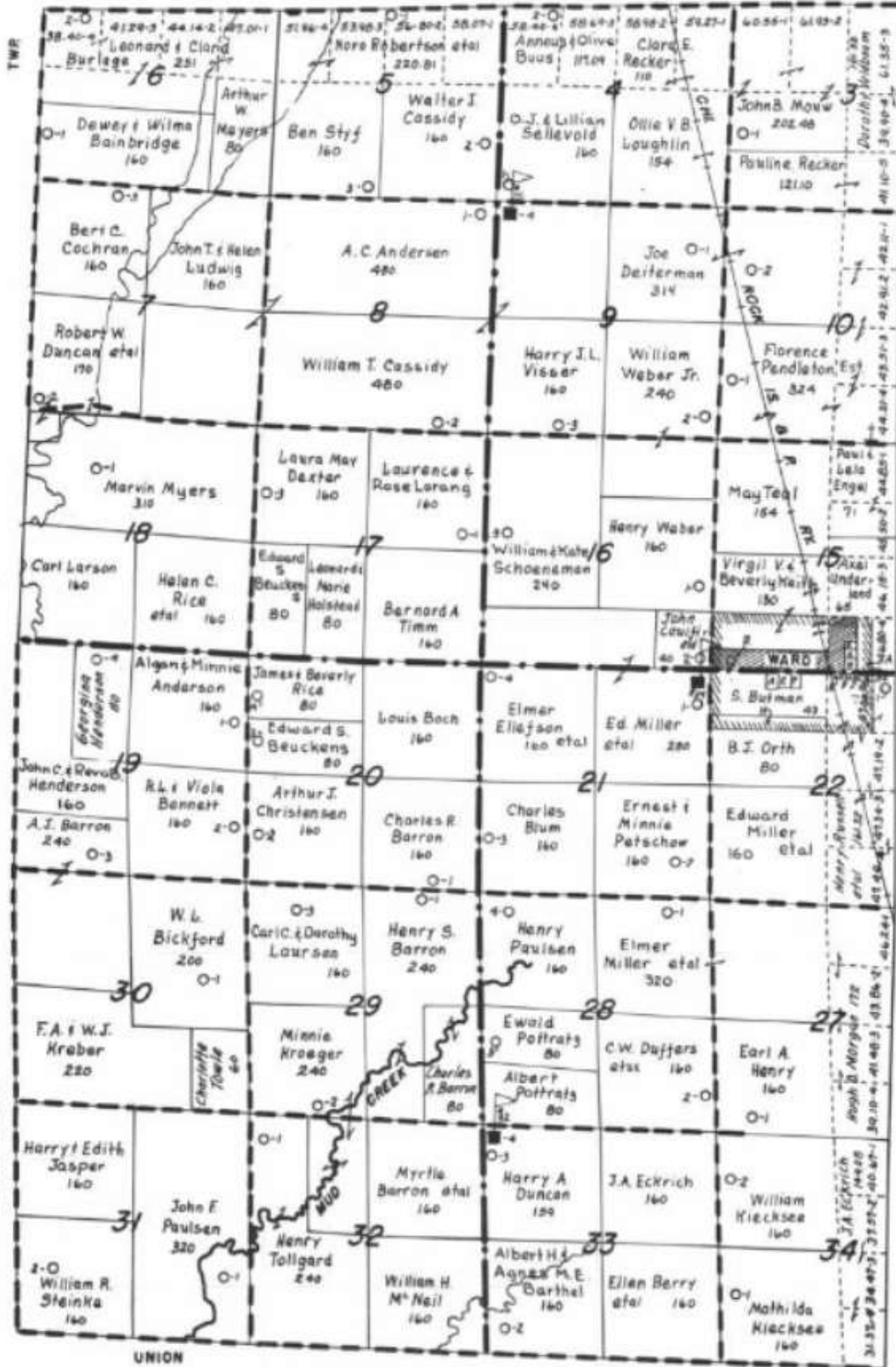

SMALL TRACT OWNERS

SEC. TRACT	OWNER	ACRES
15 A	Henry Russell	26.13
15 B	John Lembeck et al	2.47
15 C	Mrs Len Turas	2.71
15 D	Len Turas	1.00
20 A	Russell R. Butman	4.80
20 B	Farmers Union Grain Term.	0.33
21 C	Florence Kaeper	2.36
21 D	Emil Zauder	2.08
22 E	Adolph Timm	3.00
22 F	Bernard A. Timm	1.50
22 H	R.F. Russell	2.10
22 I	Byford Orth	20.00
22 J	August Barfell	1.42

TWR