

PARKSTON

LIBERTY TWP.

Scale: 300ft. = 1inch.

Michael Heisinger 15121



Cemetery

Frank Wiedman

Wm. Meyer 100

Wm. Meyer

A. H. Wright 480



John Gard 100

John Gard

Eliz. Cremer 160

Claus Stamp 160

John Gard

Est. Dun Shearer 160

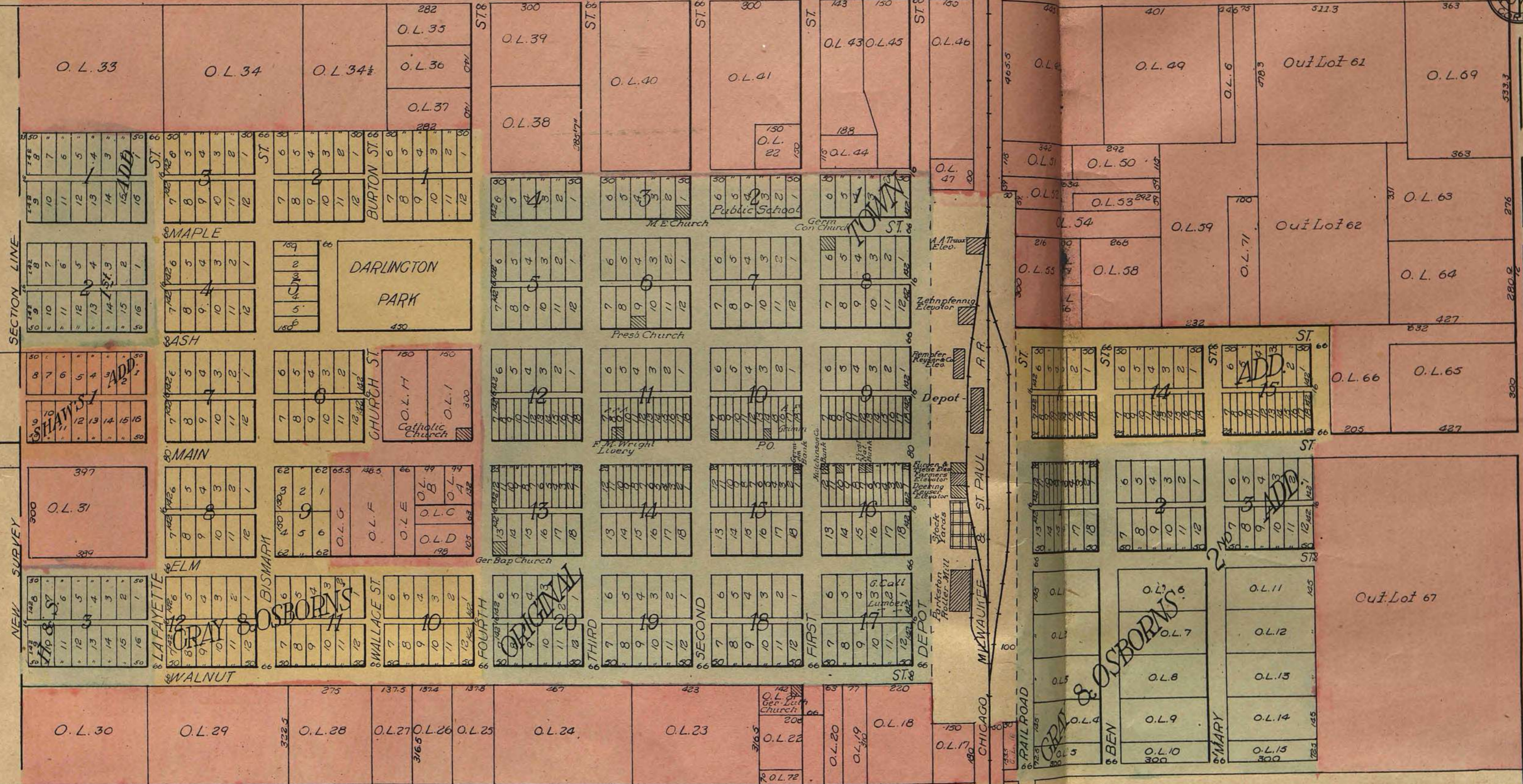

Claus Stamp

151.68

B.A. Faust 135.42

W.H. Shaw

CHICAGO, MILWAUKEE & ST. PAUL R.R.

RAILROAD

GRAY & OSBORNS

MARY

B.A. Faust 135.42

MENNO

MENNO PREC.

Scale: 300ft. 1inch.

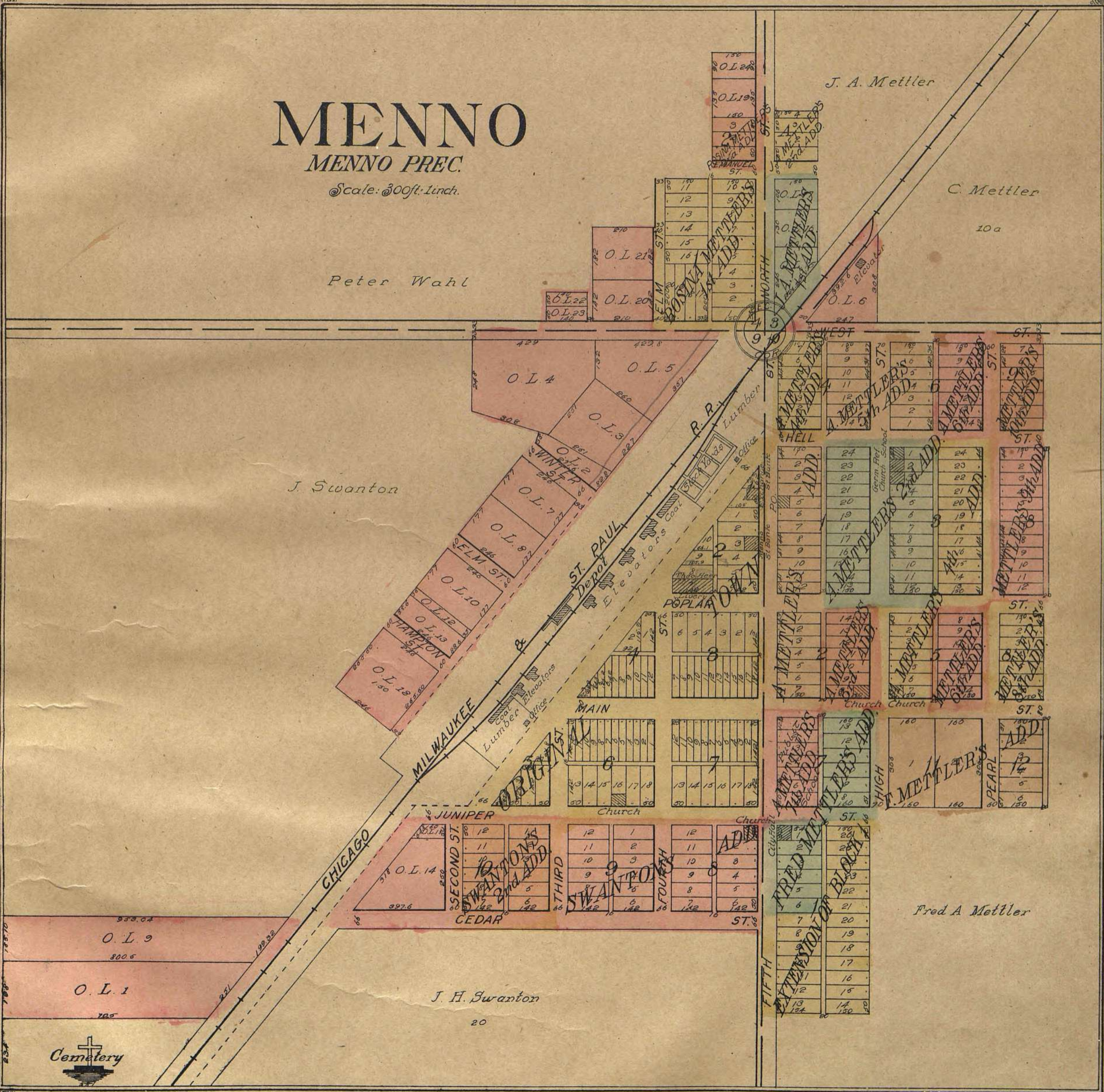

TRIPP

TRIPP PREC.

Scale: 300ft. = 1 inch.

193.30

F. F. MAYER
2975

CHICAGO, MILWAUKEE & ST. PAUL, R.R.

Henry Klatt Jr.

ADD. O.L. 63 O.L. 62 O.L. 61 O.L. 60

Hutchinson Co. Fair Assn
Grounds
Out Lot 50
18.78 ac.

Out Lot 49
730 ac.

Henry Klatt Jr
160

Out Lot 19
1000 ac.

FAIR ST. KLATT'S O.L. 59 O.L. 58 O.L. 57 O.L. 56 O.L. 55 O.L. 54 O.L. 53 O.L. 52 O.L. 51

HENRY KLATT'S O.L. 40 O.L. 41 O.L. 42 O.L. 43 O.L. 44 O.L. 45 O.L. 46 O.L. 47 O.L. 48

PLAT OF O.L. S. KLATT'S ADD. O.L. 39 O.L. 38 O.L. 37 O.L. 36 O.L. 35 O.L. 34 O.L. 33 O.L. 32 O.L. 31

PLAT OF O.L. S. O.L. 28 O.L. 27 O.L. 26 O.L. 25 O.L. 24 O.L. 23 O.L. 22 O.L. 21 O.L. 20

SHANNON'S O.L. 19 O.L. 18 O.L. 17 O.L. 16 O.L. 15 O.L. 14 O.L. 13 O.L. 12 O.L. 11 O.L. 10 O.L. 9 O.L. 8 O.L. 7 O.L. 6 O.L. 5 O.L. 4 O.L. 3 O.L. 2 O.L. 1



ORIGINAL TOWN O.L. 12 O.L. 11 O.L. 10 O.L. 9 O.L. 8 O.L. 7 O.L. 6 O.L. 5 O.L. 4 O.L. 3 O.L. 2 O.L. 1

SUB of Outlots
870 a

WATER Lot 'D' of Outlot 29
Lot 'C' of Outlot 29
4.63 a

Outlot 29
4.63 a

WILDER ST. 'A' Lot of Outlot 29

First Second Third Carpentier's Church
Dakota State Bank Elevators Depot Stock Yards
WILDER ST. CHICAGO MILWAUKEE & ST. PAUL R.R.

Out Lot 1
Out Lot 2
Out Lot 3
Out Lot 4
Out Lot 5

Out Lot 6
Out Lot 7
Out Lot 8
Out Lot 9
Out Lot 10

Out Lot 11
Out Lot 12
Out Lot 13
Out Lot 14

Out Lot 15
Out Lot 16
Out Lot 17
Out Lot 18

C. P. Hirsch Est.
40.00

CHAS. P. HIRSCH'S

Chris Serr 11870

C. Vilahur 11247

F. D. Vetter 98

Fred. Lange 216.60

J. J. Mendel
480

P. P. Kleinsasser
160

M. S. Huber
154.10

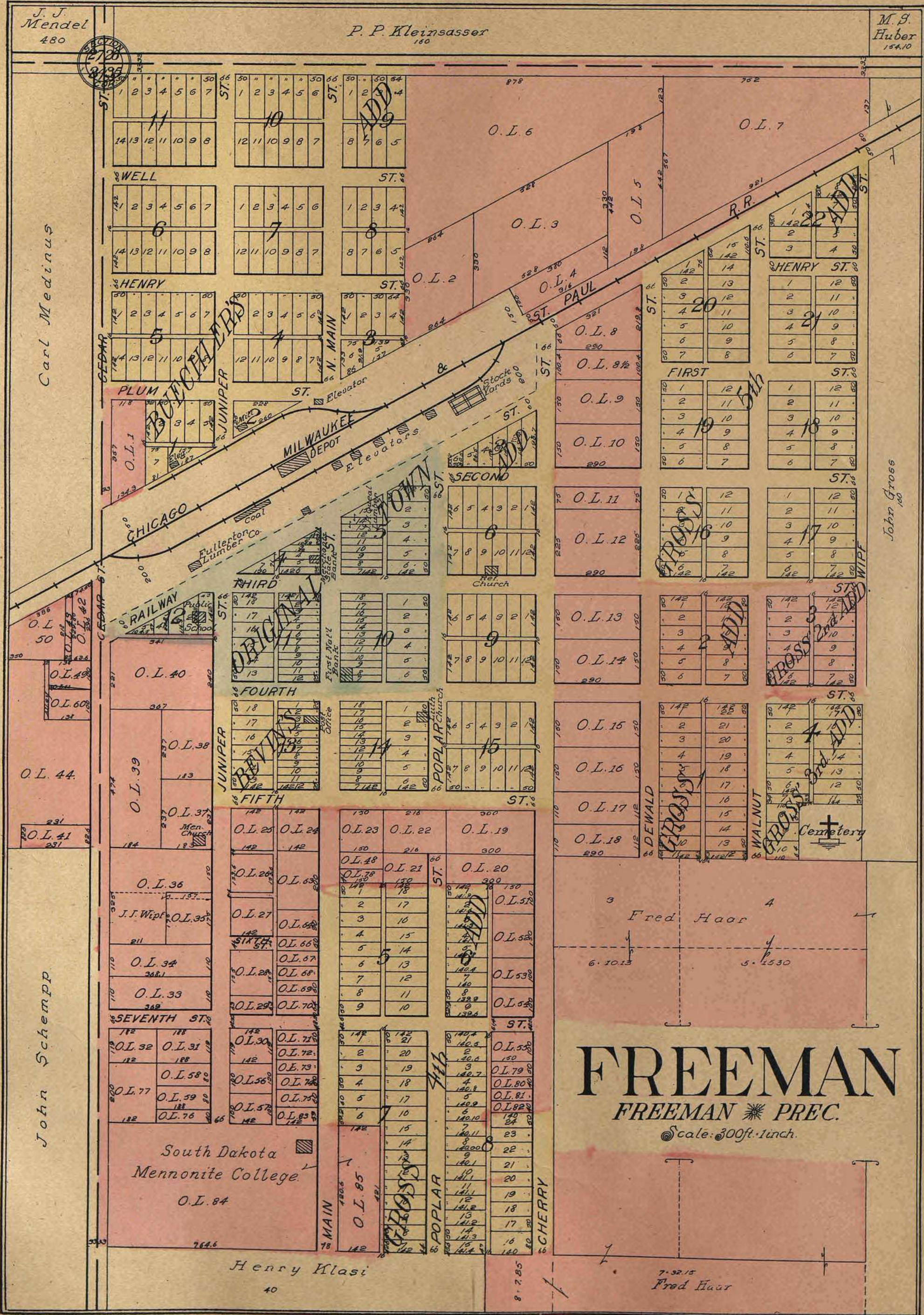

Carl Medinus

John Schempp

John Gross

FREEMAN

FREEMAN PREC.
Scale: 300ft. = 1inch.

South Dakota
Mennonite College
O.L. 84

Henry Klasi
40

7-32/15
Fred Haar

MAP OF
SOUTH PART OF MOLAN

Scale 1 1/4 inches to 1 mile

Township 97 North, Range 56 West of the 5th P.M.

NORTH PART OF MOLAN

PREC.

PREC.

CO.

4406 David F	4014 Jacob D	4020 John	4026 Geo.	4027 John	4027 Geo.	4015 Geo.	4009 Geo.	3986 Karl	3953 Karl	3920 Karl	3887 Karl	3876 Jacob B.	3921 Rev. Alb.	3965 Rev. Alb.	4011 Rev. Alb.	4009 Elias	4004 Elias	3999 Rachel	3994 Rachel	3994 Rachel	3996 Rachel	3998 Marten	4000 Marten
Heckenlaible	Heckenlaible	Knodel	Voll	Heckenlaible	Heckenlaible	Wubbena	Wipf Sr.	Wipf	Wipf	Wipf	Wipf	Wipf	Wipf	Wipf	Wipf	Wipf	Wipf	Wipf	Wipf	Wipf	Wipf	Wipf	Wipf
5	40	80	80	80	80	80	80	80	80	80	80	80	80	80	80	80	80	80	80	80	80	80	80
6	John Mandel Jr.	Lorenz Donner	Theo. Donner	Henry J. Mehlhoff	David Herrboldt	Otto Hellwig	Chris Maas	H F Harnisch	Wm. Anderson	Hanson	Will Massey	Fred Ziemann											
7	150	80	160	160	320	160	160	80	240	120	40	120											
1	Chris Mandel	John Mandel Jr.	Henry Fransch	Henry Fransch	Henry Fransch	Jacob Hauch Sr.	Jacob C. Heckenlaible	Jacob H. Schorran	Emil Utner	Jacob Hauch Sr.	Otto Hellwig	Chris Maas	Carolina Harnisch	Carolina Harnisch	Math. Guericke	Math. Guericke	Math. Guericke	Math. Guericke	Math. Guericke	Math. Guericke	Math. Guericke	Math. Guericke	Math. Guericke
2	80	80	320	320	320	80	160	160	240	80	80	240	80	80	80	80	80	80	80	80	80	80	80
3	Christian Mandel	J. J. Heckenlaible	Jacob Hauch Sr.	Emil Herrboldt	Jacob C. Heckenlaible	Jacob H. Schorran	Emil Utner	Emil Utner	Otto Hellwig	Chris Maas	Chris Maas	Carolina Harnisch	Carolina Harnisch	Fred Harnisch	Sam. Hanson	Sam. Hanson	Sam. Hanson	Sam. Hanson	Sam. Hanson	Sam. Hanson	Sam. Hanson	Sam. Hanson	Sam. Hanson
4	80	150	160	160	160	160	160	160	240	320	240	80	80	40	40	40	40	40	40	40	40	40	40
1	Karl Handel	Chris Handel	Gottlieb Schenpp	Chris Redman	Chris Redman	Henry Fransch	J. J. Heckenlaible	John M. Bender	Chris Maas	C. O. Carter	C. O. Carter	C. O. Carter	C. O. Carter	C. O. Carter	C. O. Carter	C. O. Carter	C. O. Carter	C. O. Carter	C. O. Carter	C. O. Carter	C. O. Carter	C. O. Carter	C. O. Carter
2	80	80	240	160	160	80	80	480	80	80	80	80	80	80	80	80	80	80	80	80	80	80	80
3	Jacob P. Hauch	John Weber	G. J. Will	Gottlieb Schmidt	School Land	Fred Schick	John M. Bender	John M. Bender	John M. Bender	John M. Bender	John M. Bender	John M. Bender	John M. Bender	John M. Bender	John M. Bender	John M. Bender	John M. Bender	John M. Bender	John M. Bender	John M. Bender	John M. Bender	John M. Bender	John M. Bender
4	80	160	240	160	80	40	480	480	480	480	480	480	480	480	480	480	480	480	480	480	480	480	480
1	Chris Schorran	Chris Schorran	Chris Schorran	Chris Schorran	Chris Schorran	Chris Schorran	Chris Schorran	Chris Schorran	Chris Schorran	Chris Schorran	Chris Schorran	Chris Schorran	Chris Schorran	Chris Schorran	Chris Schorran	Chris Schorran	Chris Schorran	Chris Schorran	Chris Schorran	Chris Schorran	Chris Schorran	Chris Schorran	Chris Schorran
2	40	40	40	40	40	40	40	40	40	40	40	40	40	40	40	40	40	40	40	40	40	40	40
3	Chris Schorran	Chris Schorran	Chris Schorran	Chris Schorran	Chris Schorran	Chris Schorran	Chris Schorran	Chris Schorran	Chris Schorran	Chris Schorran	Chris Schorran	Chris Schorran	Chris Schorran	Chris Schorran	Chris Schorran	Chris Schorran	Chris Schorran	Chris Schorran	Chris Schorran	Chris Schorran	Chris Schorran	Chris Schorran	Chris Schorran
4	40	40	40	40	40	40	40	40	40	40	40	40	40	40	40	40	40	40	40	40	40	40	40
1	Gottlieb Handel	Karl Schorrmann	Karl Utner	Karl Utner	Karl Utner	Karl Utner	Karl Utner	Karl Utner	Karl Utner	Karl Utner	Karl Utner	Karl Utner	Karl Utner	Karl Utner	Karl Utner	Karl Utner	Karl Utner	Karl Utner	Karl Utner	Karl Utner	Karl Utner	Karl Utner	Karl Utner
2	80	160	320	320	320	320	320	320	320	320	320	320	320	320	320	320	320	320	320	320	320	320	320
3	John Herrboldt	David Herrboldt	Chris Utner Jr.	Henry Utner	John Quast	Chris Quast	John Quast	John Quast	John Quast	John Quast	John Quast	John Quast	John Quast	John Quast	John Quast	John Quast	John Quast	John Quast	John Quast	John Quast	John Quast	John Quast	John Quast
4	80	160	320	160	160	160	160	160	160	160	160	160	160	160	160	160	160	160	160	160	160	160	160
1	W. B. Utner	David Herrboldt	Jacob N. Schaeffer	Chris Utner Jr.	George Heinrich	Chris Quast	Chris Quast	Chris Quast	Chris Quast	Chris Quast	Chris Quast	Chris Quast	Chris Quast	Chris Quast	Chris Quast	Chris Quast	Chris Quast	Chris Quast	Chris Quast	Chris Quast	Chris Quast	Chris Quast	Chris Quast
2	80	160	240	240	160	160	160	160	160	160	160	160	160	160	160	160	160	160	160	160	160	160	160
3	Andrew Utner	Harotina Utner	John P. Bender	Jacob N. Schaeffer	Chris Quast	Chris Redman	Chris Redman	Chris Redman	Chris Redman	Chris Redman	Chris Redman	Chris Redman	Chris Redman	Chris Redman	Chris Redman	Chris Redman	Chris Redman	Chris Redman	Chris Redman	Chris Redman	Chris Redman	Chris Redman	Chris Redman
4	160	40	160	160	160	160	160	160	160	160	160	160	160	160	160	160	160	160	160	160	160	160	160

MENNO

TURNER

YANKTON

CO.

MAP OF SOUTH PART OF MENNO

Scale 1/4 inches to 1 mile

Township 97 North, Range 57 West of the 5th P.M.

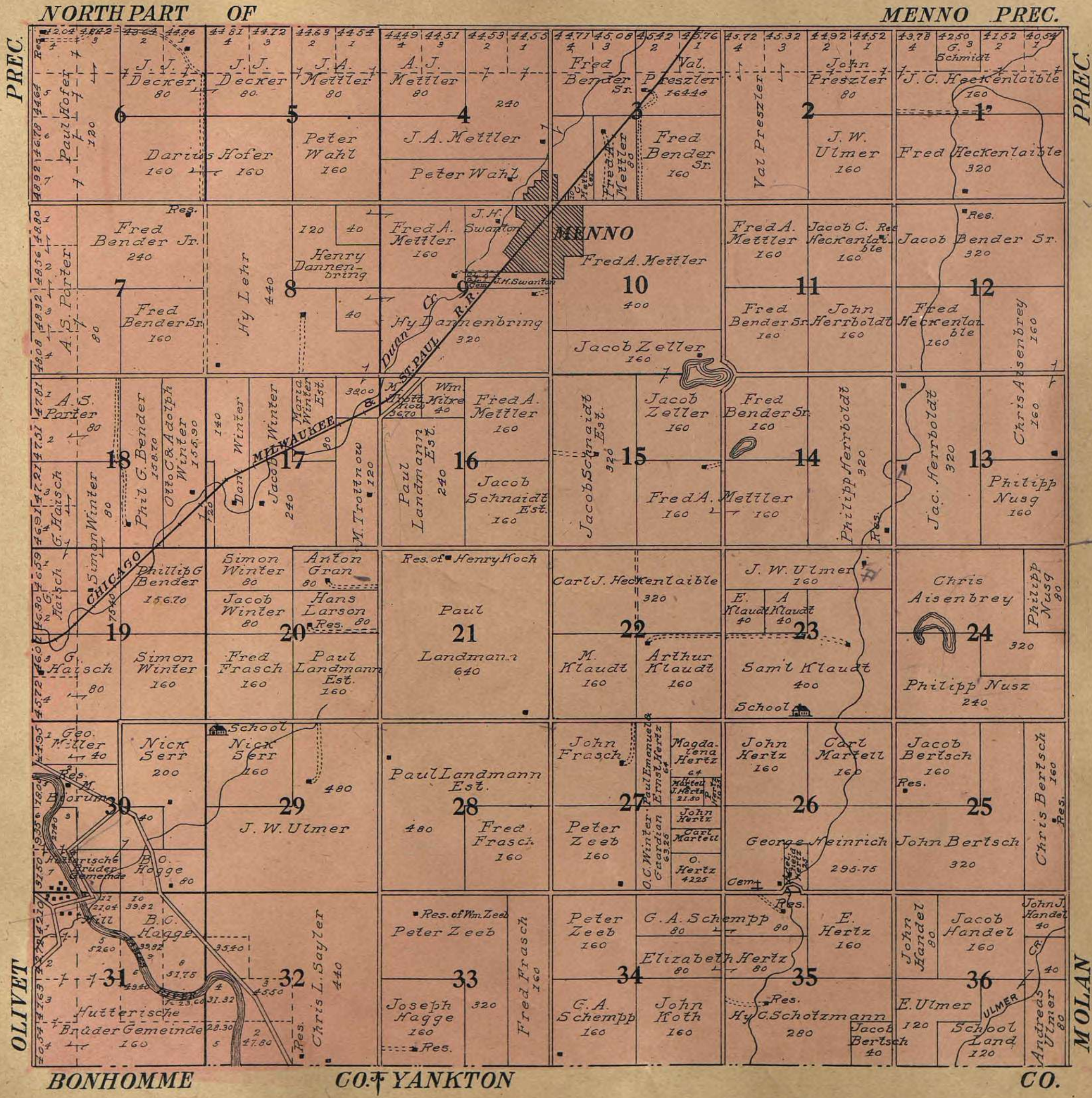

MAP OF SOUTH PART OF OLIVET

Scale 1/4 inches to 1 mile.

Township 97 North, Range 58 West of the 5th P.M.

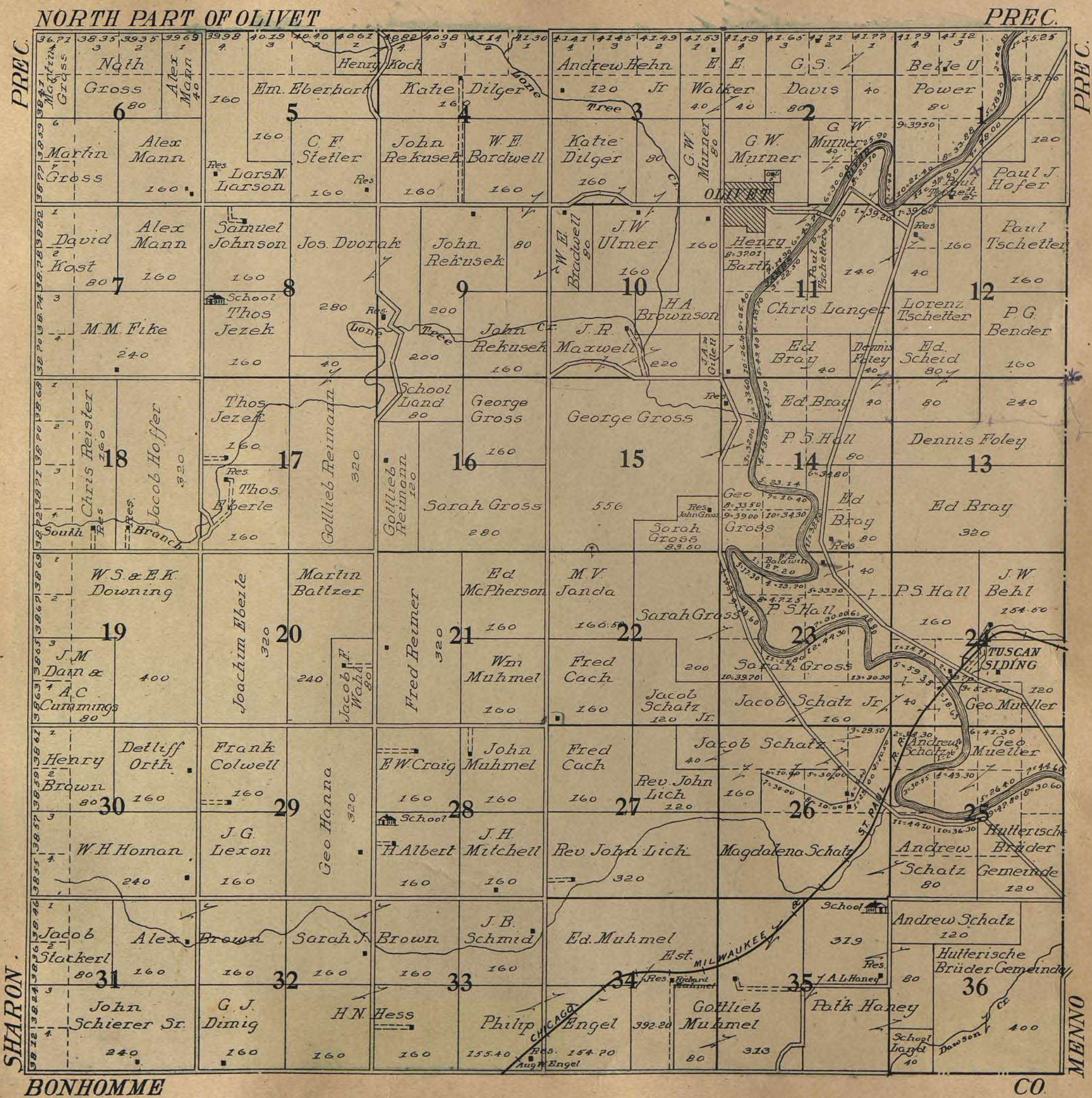

BONHOMME

CO.

MAP OF
SOUTH PART OF SHARON

Scale 1/4 inches to 1 mile

Township 97 North, Range 59 West of the 5th P.M.

NORTH PART OF

SHARON PREC.

PREC.

PREC.

3993 4 Annna Buetz 5 40	4195 3 Katherina Lehr 80	4208 2 Henry Reiner 120	4215 1 Fred Reich 240	4210 4 Kate Magstadt 120	4192 2 Ed Magstadt 160	4168 4 Jacob Magstadt 80	4167 4 Friedrich Magstadt 80	4149 2 Ed Magstadt 160	4145 2 Jacob Magstadt 160	4128 4 F. J. Fray 240	4098 3 A. M. Warner 160	4068 2 Geo. E. Scobel 80	4038 1 W. A. Cottinge 160	4006 4 Mrs M. Manderson 160 Res. of J. W. Manderson	3976 2 W. E. Colwell 160	3859 4 John Bennett 80	3832 2 John Gross 80
Jacob Stackerl 80	F. P. Feix 160	Henry Reiner 120	Fred Reich 240	Kate Magstadt 120	Ed Magstadt 160	Jacob Magstadt 160	F. J. Fray 240	A. M. Warner 160	A. M. Warner 160	Mrs M. Manderson 160 Res. of J. W. Manderson	W. E. Colwell 160	John Bennett 80	John Gross 80	Frank Tamsk 160			
Gen. Church	Phil. Friederick 480	Fred Reich 80	J & F. Magstadt 160	Jacob Stackerl 320	Andreas Baltzer 640	C. P. Lawrence 160	School	Chris Klinck 160	F. E. Haynes 160								
Wm. Ziegler 160	Geo. Anderson 160	Jacob Redmann 80	School Land	Jacob Redmann 80	Wm & J. C. Baltzer 240	C. P. Lawrence 160	School	Chris Klinck 160	F. E. Haynes 160								
Paul Friederick 160	Wm. Ziegler 160	Geo. Anderson 160	Jacob Redmann 80	School Land	Wm & J. C. Baltzer 240	C. P. Lawrence 160	School	Chris Klinck 160	F. E. Haynes 160								
John Friederick 80	Hofelman & Graf 160	Martin Rembold 80	Wm. Rembold 80	Jacob Rembold 160	John Becker 80	John Fuerst 106	Chris. Gramer 34	J. E. Richmond 160	J. E. Richmond 320	Jacob Stackerl 320	L. I. Bisetter 320	Charles N. Thompson 160	Henry Weiderbach 160				
John Friederick 80	Hofelman & Graf 160	Martin Rembold 80	Wm. Rembold 80	Jacob Rembold 320	John Becker 160	John Fuerst 160	Chris. Gramer 160	Gottlieb Dieck 320	Ludwig Saylor 160	Charles N. Thompson 320	G. W. Freese 160	Adolph Gloege 160					
Adam Weisz 240	Daniel Guszler F. J. Schmidt 160	Jacob Rembold 320	Anna M. Fuerst 320	John Fuerst 160	John Fuerst 160	Chris. Gramer 160	Gottlieb Dieck 320	School	Greenwald & Knox 480	Charles N. Thompson 320	G. W. Freese 160	Adolph Gloege 160					
Amelia Ganske 80	Frank Struebelt 160	Adam Weisz 160	Anna M. Fuerst 160	L. J. Freese 240	L. J. Freese 240	L. J. Freese 80	Gottlieb Dieck 80	Fred Fuerst 320	Res. G. R. Schlechter	Henry Brown 160							
John Weisz 80	Karl Link 160	August Link Jr. 15460	J. J. Wagner	Martin Baltzer 240	John Schmierer 160	Robert Dollard 160	Fred Fuerst 320		Res. G. R. Schlechter	Henry Brown 160							
Karl Link 160	Karl Link 240	August Link Jr. 15460	J. J. Wagner	Martin Baltzer 240	John Schmierer 160	Robert Dollard 160	Fred Fuerst 320		Res. G. R. Schlechter	Henry Brown 160							
John Gihack 160	Karl Link 80	August Link Jr. 15460	J. J. Wagner	Martin Baltzer 240	John Schmierer 160	Robert Dollard 160	Fred Fuerst 320		Res. G. R. Schlechter	Henry Brown 160							
Dave Schelske 40	Karl Link 80	August Link Jr. 15460	J. J. Wagner	Martin Baltzer 240	John Schmierer 160	Robert Dollard 160	Fred Fuerst 320		Res. G. R. Schlechter	Henry Brown 160							
	John Gihack 160	August Link Jr. 15460	J. J. Wagner	Martin Baltzer 240	John Schmierer 160	Robert Dollard 160	Fred Fuerst 320		Res. G. R. Schlechter	Henry Brown 160							
	John Gihack 160	August Link Jr. 15460	J. J. Wagner	Martin Baltzer 240	John Schmierer 160	Robert Dollard 160	Fred Fuerst 320		Res. G. R. Schlechter	Henry Brown 160							

BON HOMME

CO.

TRIPP

OLIVET

MAP OF TRIPP

Scale 1/4 inches to 1 mile

Township 97 North, Range 60 West of the 5th P.M.

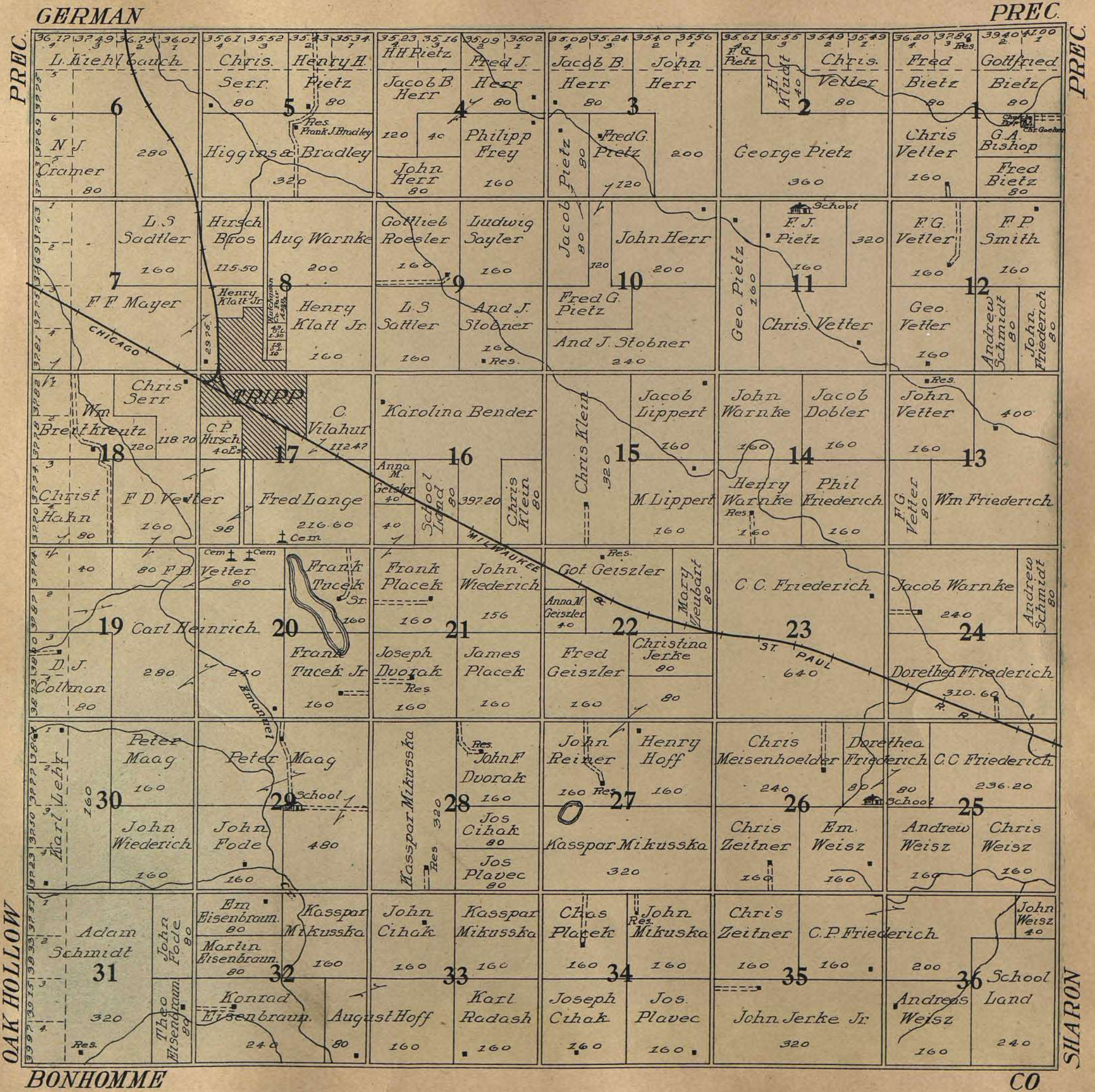

BONHOMME

CO

MAP OF
SOUTH PART OF OAK HOLLOW

Scale 1/4 inches to 1 mile

Township 97 North, Range 61 West of the 5th P.M.

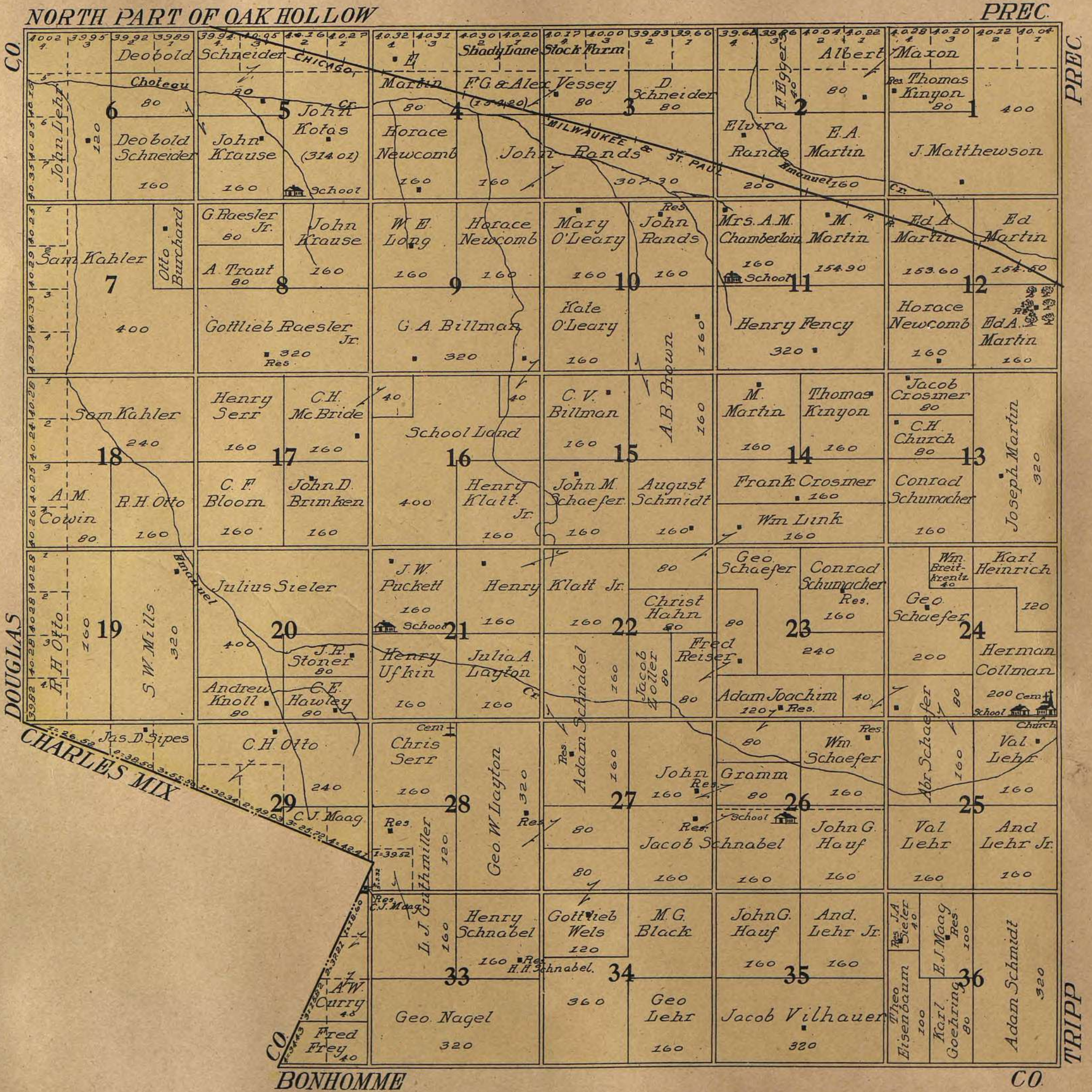

MAP OF NORTH PART OF MENNO

Scale 1/4 inches to 1 mile

Township 98 North, Range 57 West of the 5th P.M.

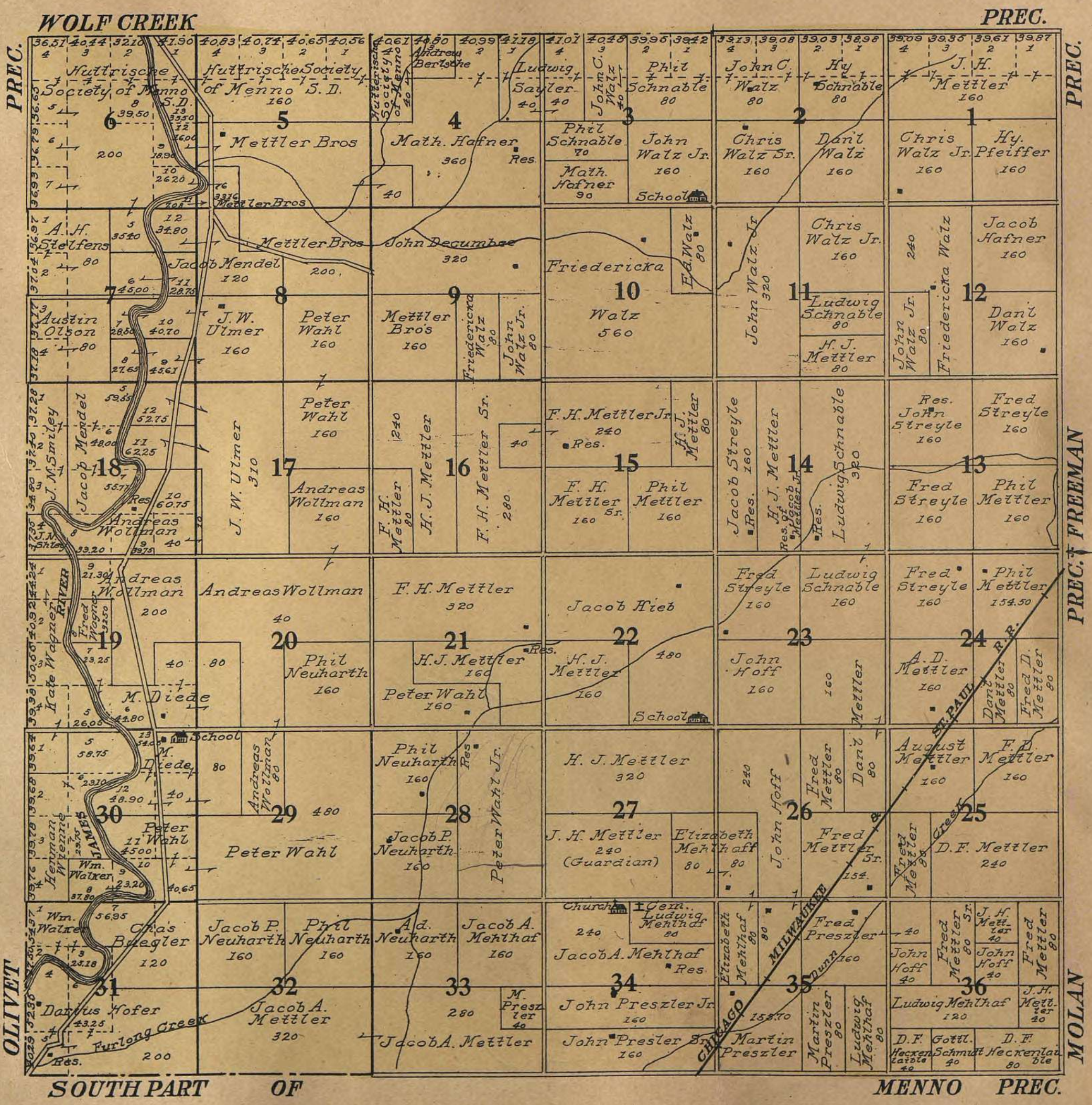

MAP OF
NORTH PART OF OLIVET

Scale 1 1/4 inches to 1 mile

Township 98 North, Range 58 West of the 5th P.M.

PREC.	MILL TOWN																PREC.	
	3958 Jacob 40	3807 Chris 80	3807 Chas. 80	3820 H. G. Baumgardner 40	3849 Fred. Larver 40	3872 M. E. 80	3894 Belton 80	3913 John Beschta 40	3932 Gast Hoeger 40	3951 Otto C. Winter 80	3972 August Wagner 80	3990 Jacob Stackerl 80	4007 Roy Grint 80	4029 Roy Grint 80	4051 Roy Grint 80	4073 Roy Grint 80	4082 Roy Grint 80	4100 Roy Grint 80
	Phil Rapp 80	Chas. Reinboldt 160	Phil Rapp 160	Jacob Stackerl 160	Fred. Hausauer 160	A. M. Sweet 160	M. A. Schlicht 160	Albert Barth 80	Fred. Barth 240	Hutterische Mennonite Society 400								
	Hart Kost 80	Phil Rapp 160	Jacob Stackerl 480		Fred. Hausauer 160	Bern Fischer 160	John Barth 248	C. B. Grint 80	Paulina Wagner 360	O. M. Lenker 320								
	C. E. Carey 80	Ed. J. Lee 160	C. W. Boegler 160	E. B. Bohner 240	Henry Neitz 80	Sarah Klonat 80	John Noll 32	John David 40	Marilina Neumann 80	Wm. Wagner 200	J. N. Shiley 160	H. A. Steffens 150						
	P. Kost 160	C. Kost 160	Wm. Wieters 160	C. W. Ellis 160	Mrs. Munters 80	School 480	Fred. Asche 160	Pat. Staine 160	Henry Spindler 160	Jacob Stackerl 160	Wm. Wagner 160							
	Henry Kost 160	Jacob Kost 160	Peter Schechel 320		John J. Boegler 40	Land 480	Henry Brower 160	John David 160	Pat. Harney 160	P. W. Zunkel 160	O. M. Lenker 160	S. S. Rames 160						
	J. Harris 80	Tim Ballman 160	Sarah Bohner 160	Oscar Boegler 80	John J. Boegler 80	G. E. Phelps 160	G. E. Phelps 160	D. D. Gano 160	Sarah Binghamon 200	W. A. Lanam 160								
	Fena Holt 80	C. W. Ellis 160	Etta M. Bradfield 160	L. C. Burgin 160	S. E. Tilton 160	Peter Simmons 160	M. T. Halphide 160	Henry Rebel 280			S. S. Rames 320	Amos Dear sr 160	Kate Wagner 160					
	Nels Hansen 160	Adolph Winter 160	J. F. Fischer 160	J. S. Doderer 160	J. G. Piper 160	S. E. Tilton 160	W. B. Baldwin 160				S. S. Rames 80	W. A. Lanam 160						
	J. Hechtenlaible 160	L. C. Burgen 320	Geo. L. Rice 160	Wesley David 160	John Foley 320						C. E. Linington 160	Minnie Steffen 160	Henry Steffen 160					
	J. Dangel 160	Geo. L. Rice 320	School J & A Dangel 160	Simon Winter 160	W. B. Baldwin 320	Jacob Hoehn 160	S. E. Tilton 160	School Land 591.80										
	R. Dangel 160	Emanuel Bernhard 240	H. E. Koch 80	T. S. Sharp 160	Albert Bunting 160	Mrs. L. F. Kuntz Bellefentlin 160	W. B. Baldwin 320											
	J. Dangel 80																	
SHARON	SOUTH PART OF OLIVET																PREC.	

MENNO

MAP OF
NORTH PART OF SHARON
 Scale 1 $\frac{1}{4}$ inches to 1 mile

Township 98 North, Range 59 West of the 5th P.M.

MILLTOWN

	PREC.	37.97 Andrew Reiman 40	37.98 August Mueller 80	37.99 John Krueger 120	38.00 Simon Schultz 40	38.01 Gust Boettcher 160	38.02 Gottfried Hoffmann 160	38.03 Hammond Netter 80	38.04 John Tiede Jr. 80	38.05 Joseph Herrman 80	38.06 Andon Herrman 80	38.07 Fred Becker 240	38.08 Jacob Heith 80	38.09 Fred Kost 80	PREC.			
		6	5	4	3	2	1											
		Jacob J. Mogck Jr. 80	John J. Mogck Sr. 160	Katherine Mogck 320	Gus. Hoffmann 160	Gottfried Hoffmann Jr. 160	Gotthilf Isaac 160	Gotthilf Hoffmann 80	August Reinhold 80	Res. Joseph Herrman 160	Fred Becker 240	Fred Becker 160	School Joseph Mogck 160	Joseph Mogck 160				
		Res. of Jacob J. Mogck Jr. 120	August Meyer School 320	August Schlenker 160	Dani. Boettcher 160	Henry Preszler 320	Gotthilf Hoffmann Jr. 80	Peter Mehthoff 80	Jacob Mogck 80	Jacob Kost 80	Res. Frank Herrman 320	Hy Mogck Sr. 160	Joseph Mogck 320					
		7	8	9	10	11	12											
		Fred Brost 40	Andrew Schlenker 160	Ed. Schlenker 160	August Kern 160	Peter Mehthoff 160	Nath Heith Res. 320				Wessel Durmeier 160	O. E. Long 160	C. E. Carey 160					
		18	17	16	15	14	13											
		Kath Mogck 40	John A. Schlenker 160	Ed. Schlenker 160	Fred Mehthoff 40	J. F. Mehthoff 40	Val Gramm 160	Val Gramm 320	Res. John F. Mehthoff 240	Peter F. Mehthoff Res. 80	O. E. Long 320	C. E. Carey 160	G. E. Carey 160					
		19	20	21	22	23	24											
		Henry Mogck 40	John Mehthoff 40	Adam Meyer 160	Jacob Meyer 160	John Brandt 320	Daniel Mehthoff 160	Fred Mehthoff Res. 160	Wm. Baltzer 80	J. C. Baltzer 320	Wm. Gloessmann 80	Hy Mogck 80	Henry Mogck 160	O. E. Long 160	Phil Kost 160			
		30	29	28	27	26	25											
		John Mehthoff 80	Fred Meyer 80	Adam Meyer 160	Jacob Meyer 160	John Brandt 240	Jacob F. Mehthoff 160	Peter Mehthoff 160	Wm. Baltzer 80	J. C. Baltzer 320	Wm. Baltzer 80	Phil Engel 160	Wm. Herrmann 160	Hy Mogck 80	Henry Mogck 160	O. E. Long 160	Ludwig Winter 160	John J. Harris 160
		31	32	33	34	35	36											
		Fred Meyer 40	Fred Meyer 40	Jacob Meyer 160	Martin Baltzer 160	John Brandt 240	Jacob Brandt 160	Fred Mehthoff 40	J. F. Mehthoff 40	Wm. Baltzer 80	Martin Herrmann 160	Wm. Baltzer 80	Albert Rakuser 160	Fred Herrmann 160	Albert Rakuser 160	Martin J. Bartkoske 160	Matthew Harris 160	
GERMAN		31	32	33	34	35	36											
		Fred Meyer 40	Fred Meyer 40	Jacob Meyer 160	Martin Baltzer 80	Peter Mehthoff 160	Peter Mehthoff 160	John Brandt 160	C. C. Friederich 160	John Brandt 160	Louis Hornish 320	George Biertz 480	Martin Herrmann 160	Albert Rakuser 160	Martin J. Bartkoske 160	Matthew Harris 160		
		L. S. Ruetzler 160	Adam Brosz 240	Ferdinand Brosz Res. 240	Adam Brosz 80	Fred Reich 320	F. C. Reich 160	Friedrich Magst 160	John Brandt 160	John Brandt 160	Louis Hornish 320	George Biertz 480	Isabella Lee 160	School Land 120	John Grosz 380	Alex. Mann 80		
		31	32	33	34	35	36											
		31	32	33	34	35	36											

SOUTH PART OF SHARON

OLIVET

MAP OF
GERMAN

Scale 1/4 inches to 1 mile

Township 98 North, Range 60 West of the 5th P.M.

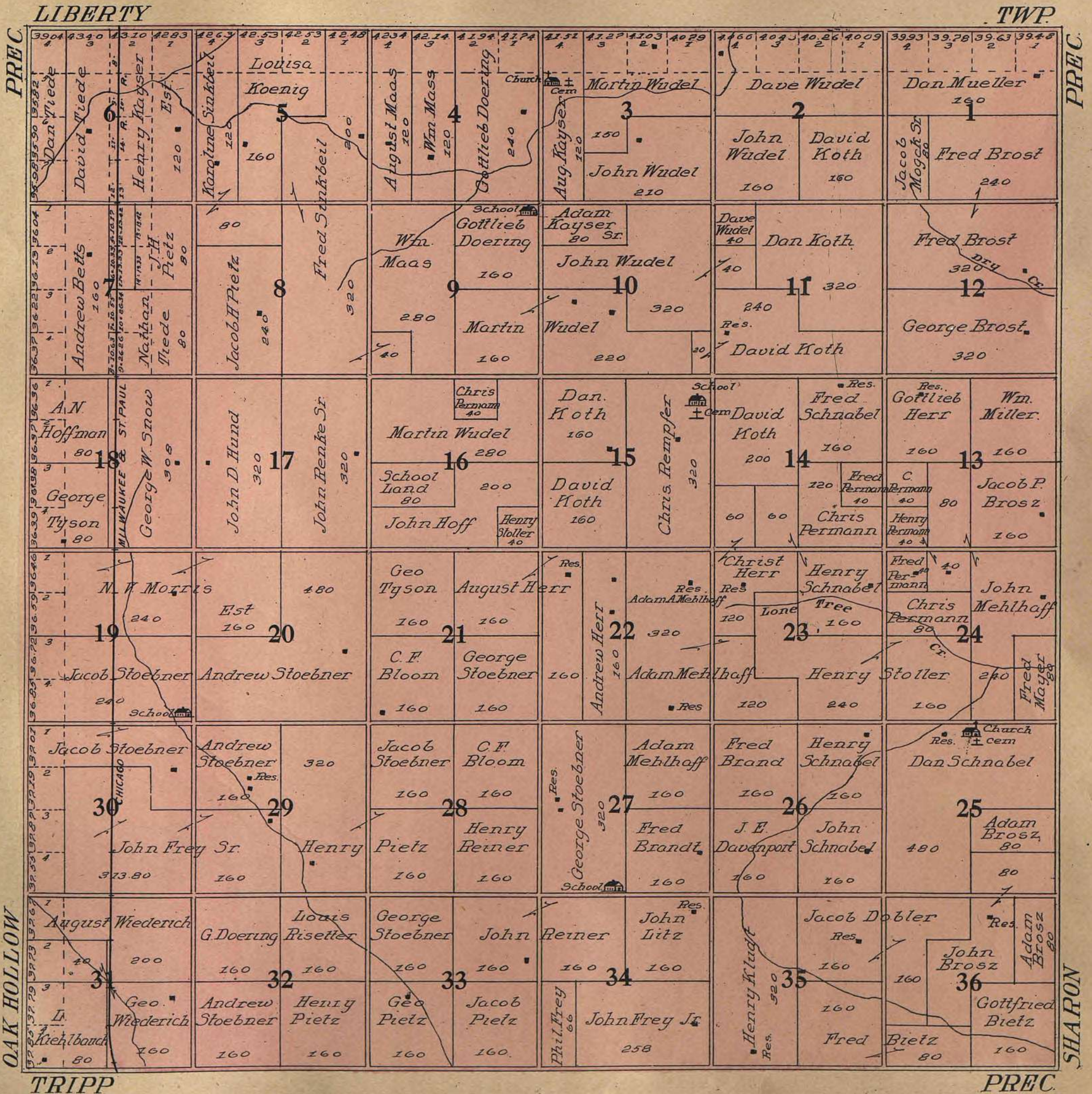

MAP OF
NORTH PART OF OAK HOLLOW

Scale 1 1/4 inches to 1 mile

Township 98 North, Range 61 West of the 5th P.M.

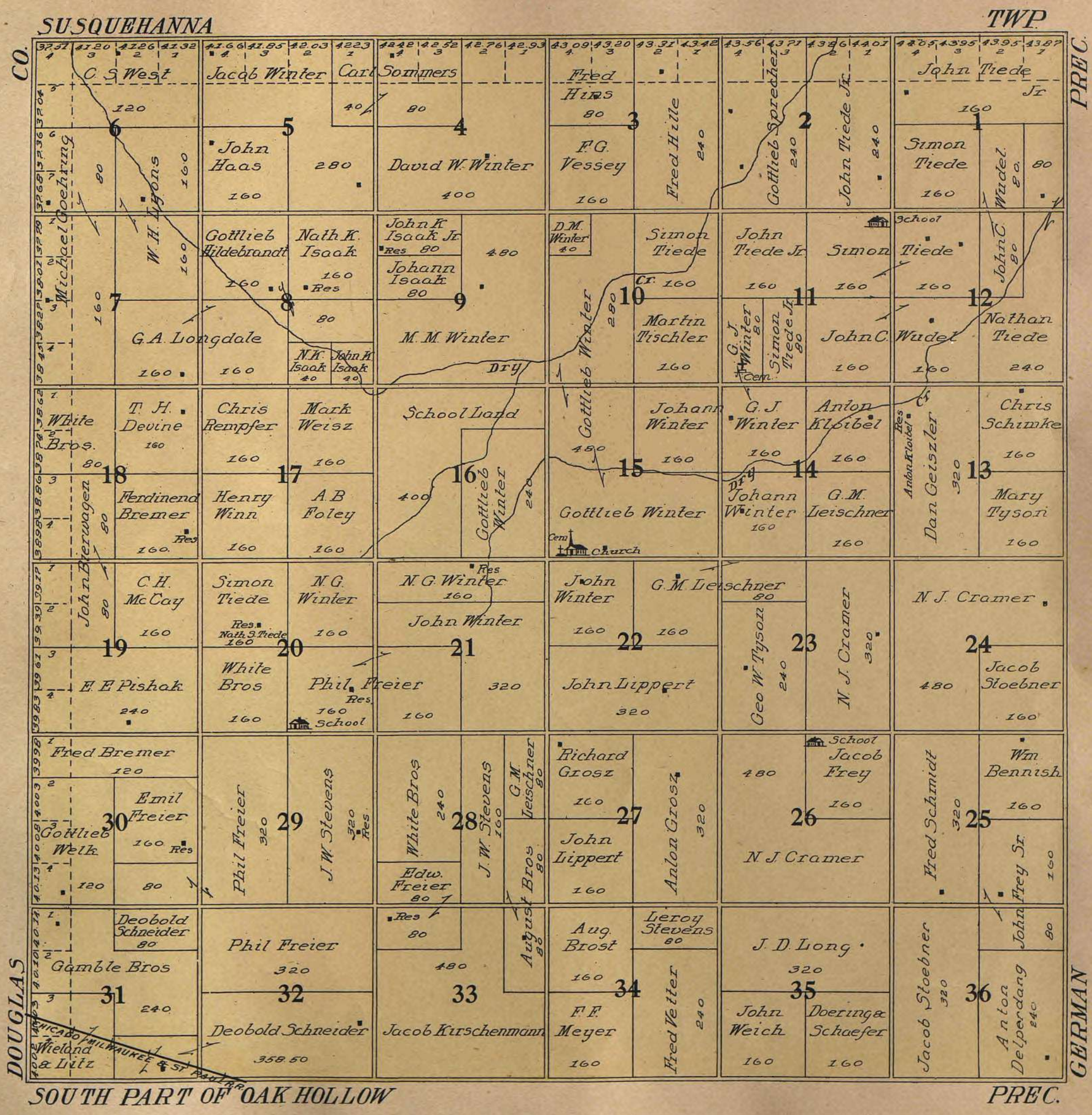

MAP OF NORTH PART OF FREEMAN

Scale 1 1/4 inches to 1 mile

Township 99 North, Range 56 West of the 5th P.M.

	SILVER LAKE													
PREC													CO	
	40.10 4 Hy Goehring 40.	40.08 3 Geo. Aman 80.	40.12 2 360.	40.15 1 39.86 3 Jacob A. Koerner 120.	39.82 2 Joseph Walter 80.	39.68 1 Elix. Hoerner 80.	39.48 4 Michael R. Hofer 80.	39.25 3 Joshua R. Hofer 80.	39.02 2 Michael Hofer	38.79 1 D. D. Gross 320.	39.43 4 Cornelius Becker 80.	39.59 3 Jacob R. Becker 80.	39.75 2 Fred Dirks 240.	39.91 1 Jacob Schartner 80.
	40.54 6 Joseph Walter 80.	40.54 5 Hy Goehring 160.	40.71 7 George Aman	40.54 5 John A. Koerner 40.	40.54 4 John R. Hofer 240.	40.54 3 J. S. Decker 320.	40.54 2 D. D. Gross 160.	40.54 1 Fred Dirks 240.	40.54 1 Jacob Schartner 80.					
	40.81 1 Jacob Hofer 80.	40.81 2 Wm. J. Walter 160.	40.81 3 Wm. J. Walter 160.	40.81 4 Peter Mendel Sr. 160.	40.81 5 Geo. Aman 160.	40.81 6 Peter Mendel 100.	40.81 7 Jacob S. Decker 80.	40.81 8 Michael R. Hofer 160.	40.81 9 D. D. Gross 160.	40.81 10 Reg. Jacob W. Kleinsasser 160.	40.81 11 John Ratzlaff 80.	40.81 12 Andrew H. Goehring 80.	40.81 13 Peter L. Thomas 160.	40.81 14 John Ratzlaff 160.
	41.09 3 Margaret Tschetter 80.	41.09 2 Paul Walter 160.	41.09 1 J. I. Walters 160.	41.09 1 Joseph Wurz Jr. 160.	41.09 2 Joseph Wurz Sr. 160.	41.09 3 Peter Mendel 100.	41.09 4 I. J. Tschetter 80.	41.09 5 I. T. Kleinsasser 160.	41.09 6 Paul Kleinsasser 80.	41.09 7 Paul Kleinsasser 320.	41.09 8 Peter Waldner 160.	41.09 9 Cornelius Wedel 160.	41.09 10 Peter Waldner 160.	41.09 11 Cornelius Wedel 160.
	41.28 1 Jacob M. Waldner 160.	41.28 2 Paul D. Gross 80.	41.28 3 S. B. Haer 32.	41.28 4 Peter Mendels 88.	41.28 5 Jacob P. Mendel 200.	41.28 6 Joseph Wurz Jr. 160.	41.28 7 D. J. Mendel 40.	41.28 8 Treyett Mattis 120.	41.28 9 Michael Hofer 320.	41.28 10 Isaak J. Tschetter 160.	41.28 11 Cornelius Wedel 80.	41.28 12 Joseph J. Tschetter 80.	41.28 13 John F. Kleinsasser 80.	41.28 14 Ludwig Thomas 160.
	41.20 3 David Wolmann 80.	41.20 2 Jacob Stackerl 160.	41.20 1 Jacob Stackerl 160.	41.20 1 P. P. Mendel 160.	41.20 2 Jacob Hofer 160.	41.20 3 Joseph Wurz Jr. 80.	41.20 4 Andrew Polman 80.	41.20 5 Matthew J. Tschetter 160.	41.20 6 Phil. Mensch 160.	41.20 7 Lorenz Tschetter 320.	41.20 8 Paul H. Tschetter 240.	41.20 9 Katharina Schroeder 120.	41.20 10 Katharina Schroeder 120.	41.20 11 Katharina Schroeder 80.
	41.16 4 David Wolmann 320.	41.16 3 Jacob J. Haer 160.	41.16 2 Michael Waldner 320.	41.16 1 P. P. Mendel 160.	41.16 1 Andrew Hofer 160.	41.16 2 John Aman 240.	41.16 3 Geo. Aman 80.	41.16 4 J. S. Hadley 320.	41.16 5 Jacob Tschetter 160.	41.16 6 Lorenz Tschetter 80.	41.16 7 Joseph Tschetter 400.	41.16 8 Paul Tschetter Est. 480.	41.16 9 Katharina Schroeder 80.	41.16 10 Katharina Schroeder 80.
	41.59 1 David Wolmann 320.	41.59 2 Jacob J. Haer 160.	41.59 3 Michael Waldner 320.	41.59 4 P. P. Mendel 160.	41.59 5 Andrew Hofer 160.	41.59 6 John Aman 240.	41.59 7 Geo. Aman 80.	41.59 8 J. S. Hadley 320.	41.59 9 Jacob Tschetter 160.	41.59 10 Lorenz Tschetter 80.	41.59 11 Joseph Tschetter 400.	41.59 12 Paul Tschetter Est. 480.	41.59 13 Katharina Schroeder 80.	41.59 14 Katharina Schroeder 80.
	41.69 1 Jacob Walter 160.	41.69 2 Jacob J. Hofer 320.	41.69 3 Hath. Hofer 40.	41.69 4 Joshua D. Hofer 40.	41.69 5 Jacob Hofer 80.	41.69 6 Jacob Hofer 80.	41.69 7 Jacob Kleinsasser 320.	41.69 8 Geo. Aman 160.	41.69 9 J. J. Mendel 480.	41.69 10 John L. Wipf 160.	41.69 11 Joseph Tschetter Jr. 160.	41.69 12 David R. Wipf 160.	41.69 13 A. J. Wipf 80.	41.69 14 Mary Mc. Cabe 159.90.
	41.83 3 Jacob Walter 160.	41.83 2 Jacob J. Hofer 320.	41.83 1 Joseph D. Hofer 80.	41.83 1 John K. Hofer 120.	41.83 2 J. D. Hofer 80.	41.83 3 Jacob Hofer 80.	41.83 4 Jacob Kleinsasser 320.	41.83 5 Geo. Aman 160.	41.83 6 Andrew Polman 160.	41.83 7 P. P. Kleinsasser 160.	41.83 8 M. S. Huber 154.10.	41.83 9 M. S. Huber 155.	41.83 10 M. S. Huber 159.90.	41.83 11 Mary Mc. Cabe 159.90.
	42.14 1 Sam Walter 83.	42.14 2 Joseph C. Kleinsasser 317.	42.14 3 Joseph C. Kleinsasser 160.	42.14 4 Peter W. Tschetter 320.	42.14 5 Res. Tschetter 160.	42.14 6 Geo. W. Tschetter 160.	42.14 7 Andrew Polman 160.	42.14 8 Andrew J. Wolmann 226.	42.14 9 Carl Medinus 160.	42.14 10 John Gross 160.	42.14 11 John D. Mettler 160.	42.14 12 John D. Mettler 160.	42.14 13 John D. Mettler 160.	42.14 14 John D. Mettler 160.
	42.96 4 John D. Hofer 80.	42.96 3 Joseph C. Kleinsasser 317.	42.96 2 Joseph C. Kleinsasser 160.	42.96 1 Peter W. Tschetter 320.	42.96 1 Res. Tschetter 160.	42.96 2 Geo. W. Tschetter 160.	42.96 3 Andrew Polman 160.	42.96 4 Andrew J. Wolmann 226.	42.96 5 Carl Medinus 160.	42.96 6 John Gross 160.	42.96 7 John D. Mettler 160.	42.96 8 John D. Mettler 160.	42.96 9 John D. Mettler 160.	42.96 10 John D. Mettler 160.
	43.37 4 John D. Hofer 80.	43.37 3 Joseph C. Kleinsasser 317.	43.37 2 Joseph C. Kleinsasser 160.	43.37 1 Peter W. Tschetter 320.	43.37 1 Res. Tschetter 160.	43.37 2 Geo. W. Tschetter 160.	43.37 3 Andrew Polman 160.	43.37 4 Andrew J. Wolmann 226.	43.37 5 Carl Medinus 160.	43.37 6 John Gross 160.	43.37 7 John D. Mettler 160.	43.37 8 John D. Mettler 160.	43.37 9 John D. Mettler 160.	43.37 10 John D. Mettler 160.
WOLF CREEK	SOUTH PART OF FREEMAN												TURNER	

MILWAUKEE

CHICAGO

FREEMAN

PREC.

MAP OF WOLF CREEK

Scale 1 1/4 inches to 1 mile

Township 99 North, Range 57 West of the 5th P.M.

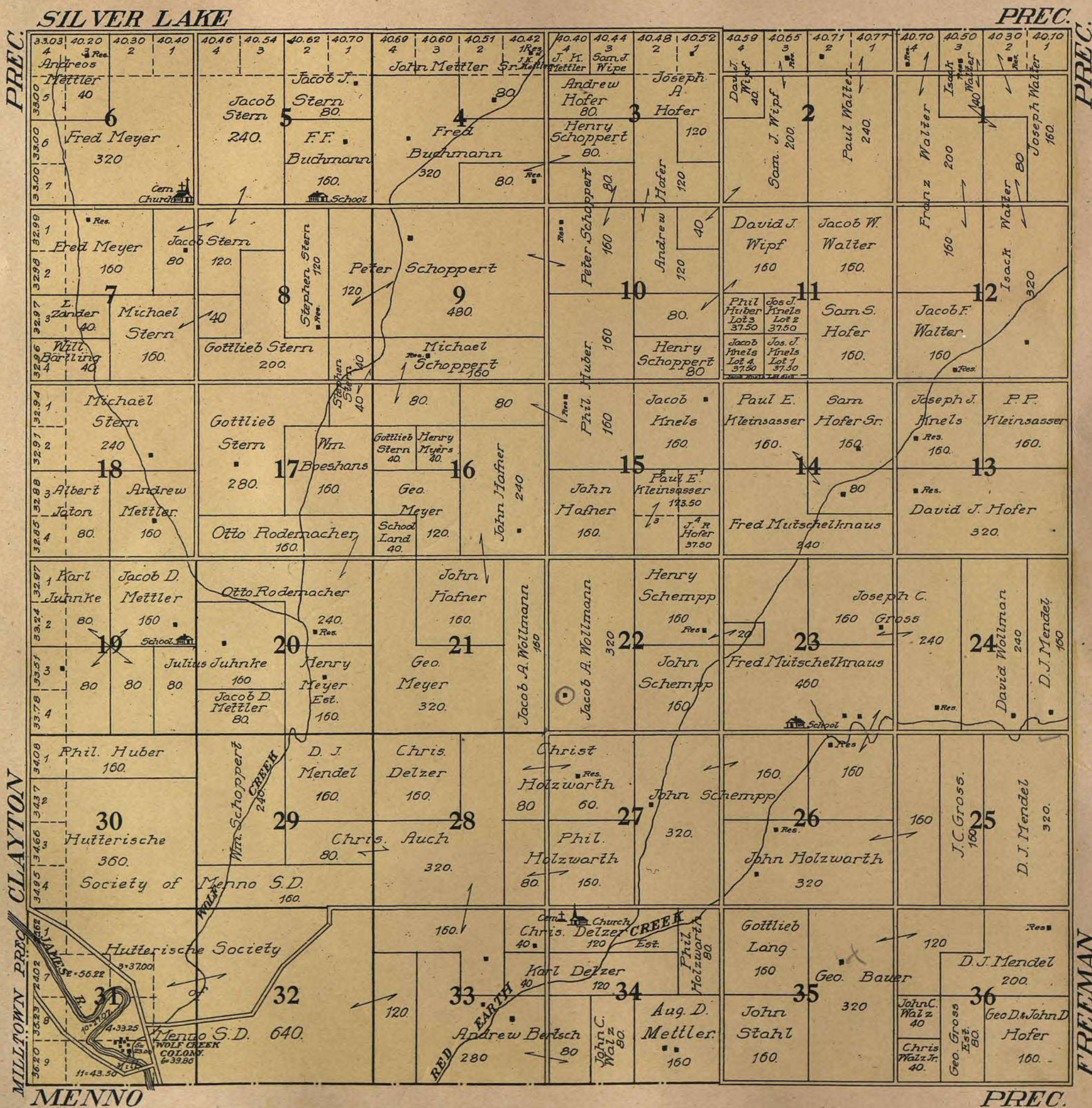

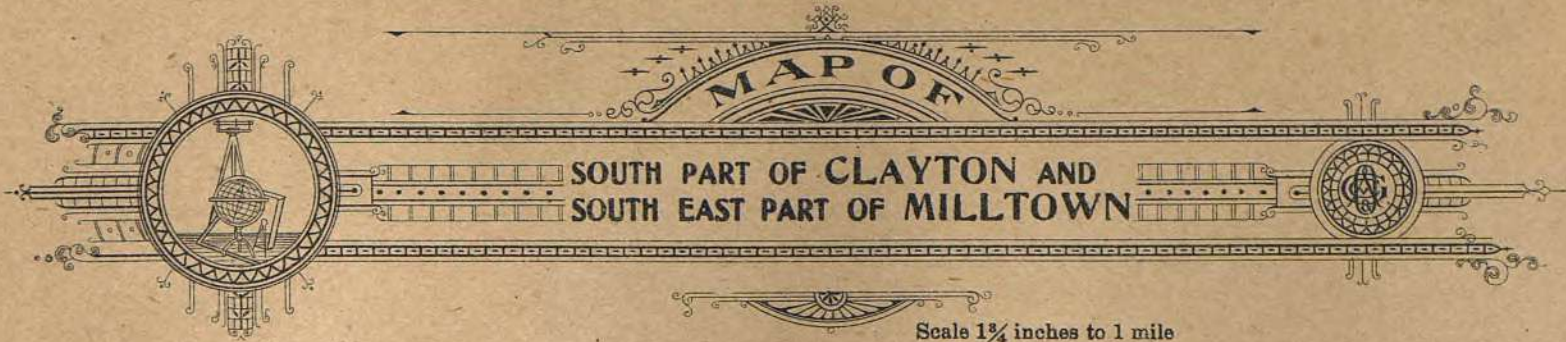

Township 99 North, Range 58 West of the 5th P.M.

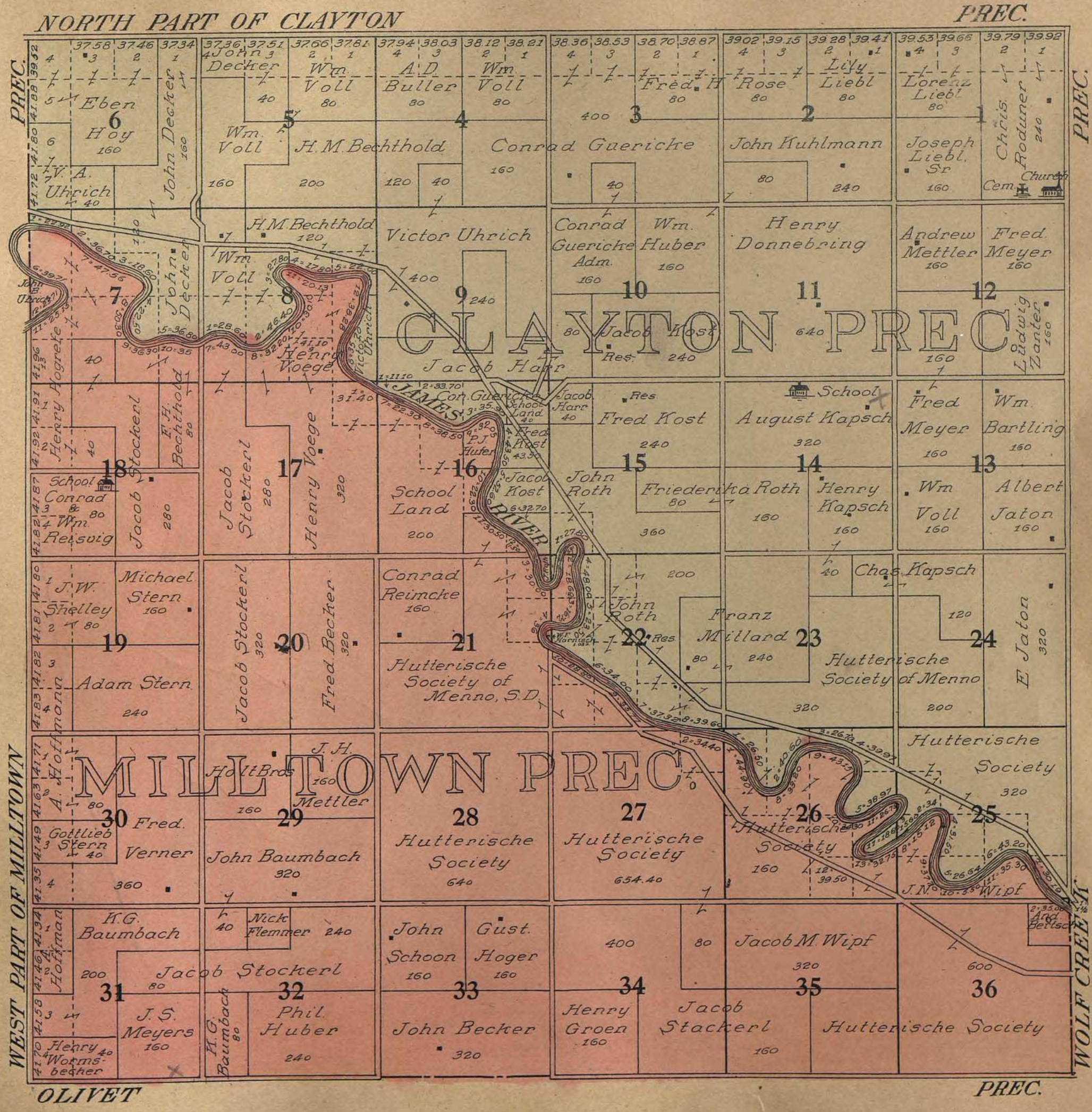

MAP OF
SOUTH PART OF MILLTOWN

Scale 1/4 inches to 1 mile

Township 99 North, Range 59 West of the 5th P.M.

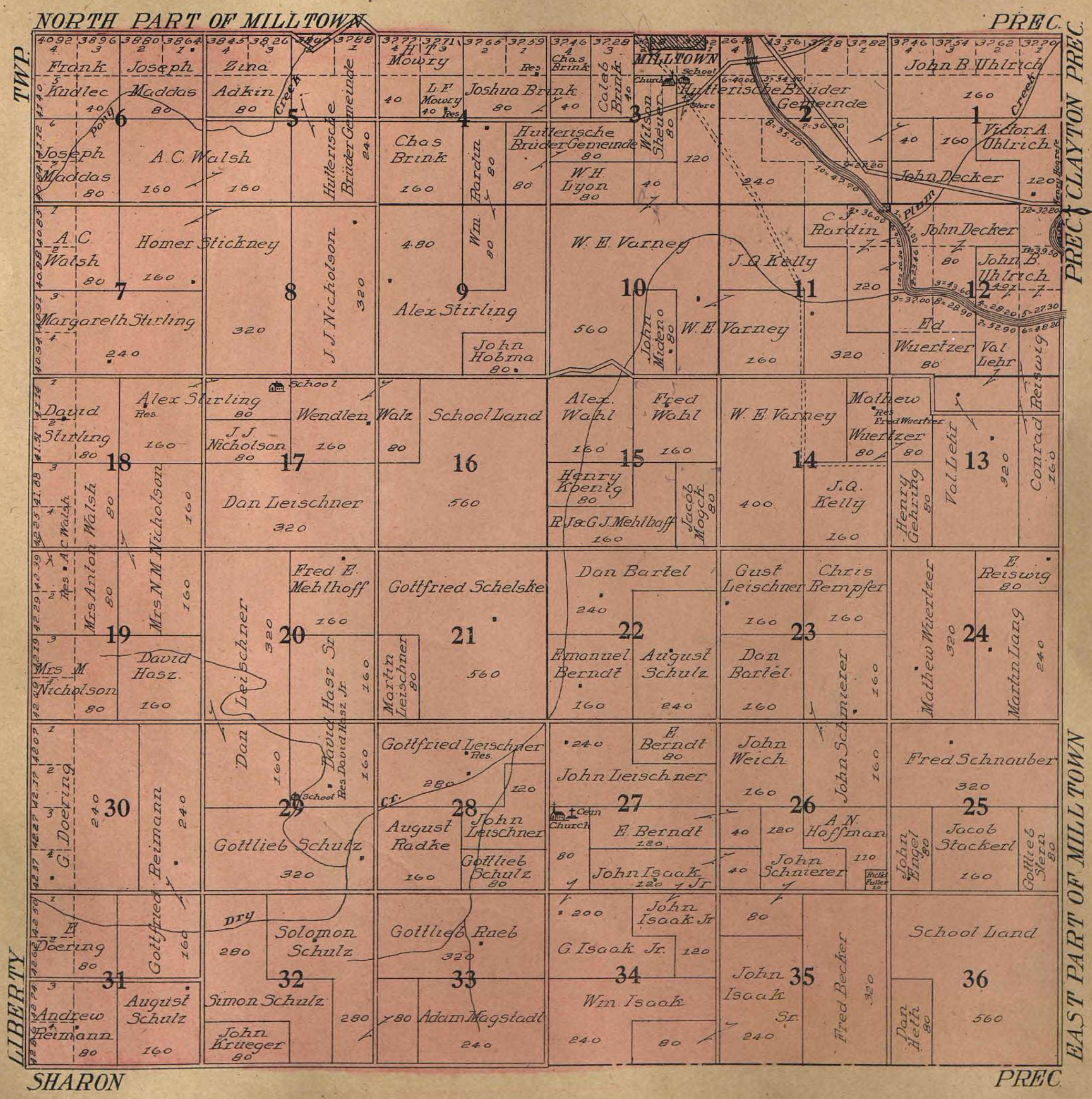

MAP OF LIBERTY

Scale 1 1/4 inches to 1 mile

Township 99 North, Range 60 West of the 5th P.M.



MAP OF SUSQUEHANNA

Scale 1/4 inches to 1 mile

Township 99 North, Range 61 West of the 5th P.M.

STARR										TWP									
3497 Mrs. Smith 40.85	4102 P. E. 2	4118 John 3	4124 Neuheisel 3	4130 Dr. D. Rust 2	4136 Joseph 1	4140 John H. 4	4141 Meinen 3	4146 Jacob 2	4151 Menderschmidt 1	4158 Theo. 2	4161 Thoma 2	4164 A.P. Vincent 1	4167 A.P. Vincent 1	4157 A.P. Vincent 1	4136 A.P. Vincent 1	4115 Anton 2	40.94 Anton 2		
3475 John C. 80	80	80	80	80	80	80	80	80	240	80	80	80	80	80	80	80	80		
3476 Mistereh 80	T.T. Wicks 160	Casper Fergers COFFEE 320		Brown 80	F.W. Eimers 240	Henry Bollweg 160	Jacob Menderschmidt School 240			Frank Iseninger 100	Bernard Breckweg 160			Titus Heisinger 100		Mrs. Devitt 160			
3496 Joseph Horstman 40	Gottlieb Moehr 160	Arnold Seelen 160	Casper Fergers 160	R.W. 80	F.W. Eimers 240					Frank Iseninger 80	Ferd. Hanlock 160			Titus Heisinger 160		Geo. Heisinger 160			
3498 Carl Moeller Sr. 80	Frank 160	Harding 160	T.T. Wicks 160	Frank Fryza 160	John Bach Sr. 160	John Nuebel 320		Henry Duenwald 160		John Heidner Sr. 160	Carl Radke 160			Lizzie Pape 160		Wm. Meyer 160			
3509 Carl Moeller Sr. 80	R.E. Nix 160	Louisa Chladek 160	Joseph Kopel 160	Frank Fryza 80	John Wagner 80			Eliz. Cremer 160		Matt. Claseman 160	Ed. Martin 160			Carl Radke 160		John Gard 160			
3527 Theresa Schoenhauer 240		Emilia Sommers 160	Peter Wagner 160	PONY School Land 480				John Doering 140	George Friederich 180		Joseph Friedrich 160			Geo. Friedrich 160		Carl Radke 80	Claus Stamp 80		
3548 Frank Thuringer 80	John Schmidt 160	Geo. Friederich Jr. 160			Wm. Friederich 80			George Friederich 160		Frank Humann 80	Henry Paepe 240			Geo. Friedrich 160		Carl Radke 80	Claus Stamp 80		
3566 D.G. Hildebrand 240	J.M. Schaeffer 160	Frank Ebersdoerfer 160		Frank Heirigs 320	Josephine Ruettgers 160	John Tiede Sr. 160		Salomon Tiede 160		Daniel Hildebrand 320				Henry Paepe 80		Chris Fischer 240			
3587 Fischer Bros. 80	Andrew Lang 160	C.F. Ebersdoerfer 160		John M. Schaeffer 320		John Tiede Sr. 480				S.H. Hildebrand 160	Gottlieb Winter 160			Chris Fischer 240					
3592 Andrew Loos 80	D.G. Hildebrand 160	W.H. Lyons 160		Wm. Isaaq Jr. 320				Martin Tiede 160			S.H. Hildebrand 120			Gottlieb Winter 240		Nath Hins. 160			
3605 John L. Schmidt 80	Danl. Shearer 160	T.T. Wicks 160	Frank Lang 160	W.H. Lyons 160	Wm. Isaaq Jr. 320	John Sprecher 160	Church Martin 160							Gottlieb Winter 160		Nath Hins. 160	Danl. Tiede 80		
3625 C.E. Franklin 80	G.S. West 160	C.S. West 160	Chas. Sommer 160	Danl. Sprecher 160	Wm. Ziegler 160	Jacob Winter 240	David Winter 80			David Winter 480				Gottlieb Winter 80		John Tiede Jr. 160	David Tiede 160		

OAKHOLLOW

PREC

LIBERTY

MAP OF
EAST PART OF SILVER LAKE

Scale 1/4 inches to 1 mile

Fractional Township 100 North, Range 56 West of the 5th P.M.

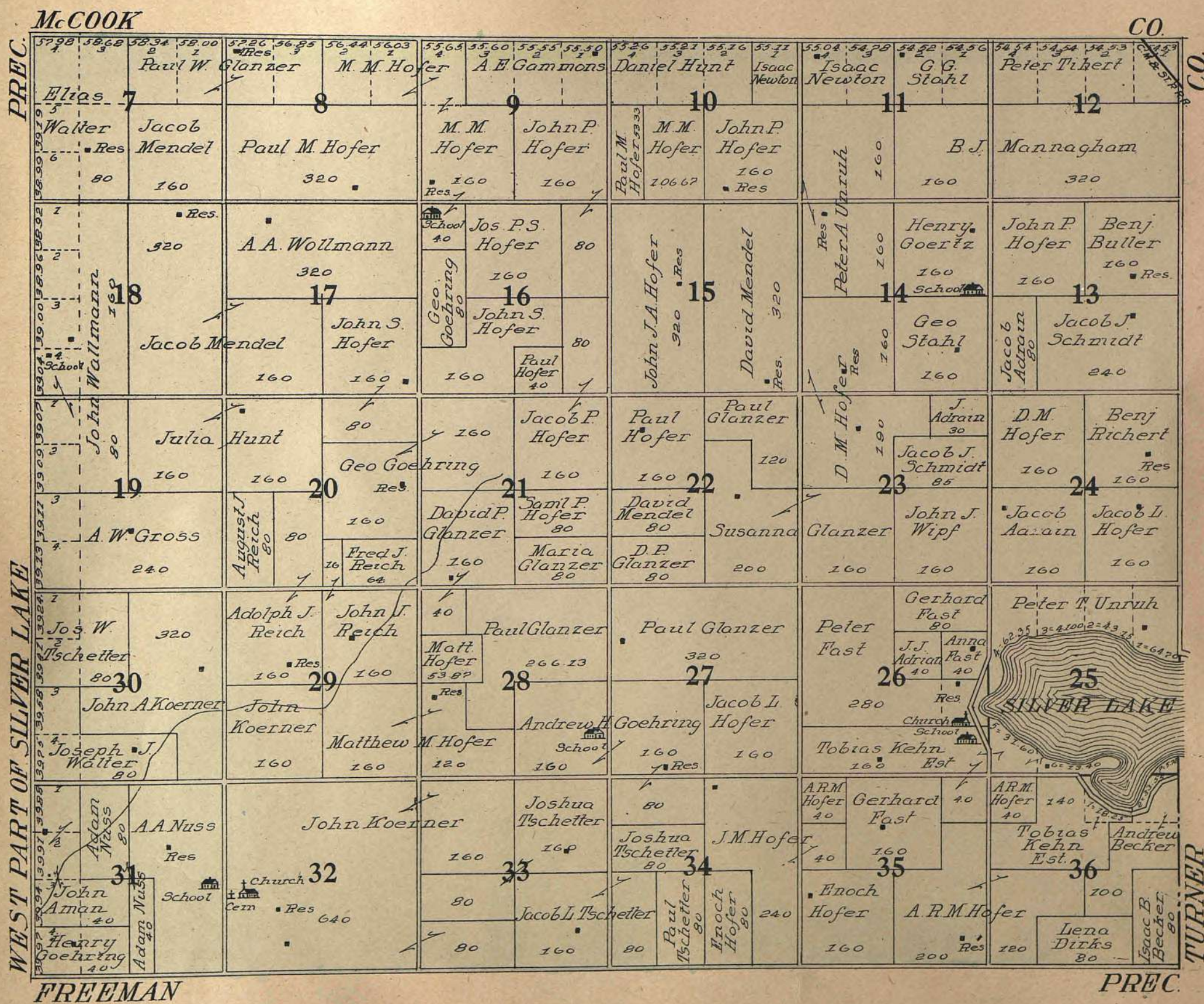

MAP OF
WEST PART OF SILVER LAKE

Scale 1/4 inches to 1 mile

Fractional Township 100 North, Range 57 West of the 5th P.M.

HANSON		CO. McCOOK												CO.		
PREC	7	Fred H. Meitler	Ludwig Schnabel	Fred Marquardt	Paul J. Tschetter	Joseph J. Glanzer	Joshua M. Hofer	Samuel Glanzer	Joshua M. Hofer	Joseph L. Hofer	Joseph A. Wipf	Joseph A. Wipf	J.M. Hofer	12	Joseph A. Wipf	J.M. Hofer
	8	John D. Hofer	John D. Hofer	John D. Hofer	Paul W. Gross	Paul P. Tschetter	Paul P. Tschetter	Samuel Glanzer	Samuel Glanzer	Joseph L. Hofer	Joseph A. Wipf	Joseph A. Wipf	J.M. Hofer	11	Joseph L. Hofer	J.M. Hofer
	9	John Voss	Paul J. Pollmann	Jacob H. Tschetter	Paul W. Gross	Paul W. Gross	David J. Glanzer	Samuel Glanzer	Samuel Glanzer	David J. Glanzer	J.W. Tschetter	J.W. Tschetter	D.M. Hofer	10	Joseph L. Hofer	J.M. Hofer
	10	Fred Marquardt	Joseph Pollmann	Joseph Pollmann	David D. Hofer	J.H. Tschetter	J.J. Glanzer	Joseph Glanzer	Joseph Glanzer	David J. Glanzer	J.W. Tschetter	J.W. Tschetter	D.M. Hofer	13	Joseph L. Hofer	J.M. Hofer
	11	John Schaeffer	Fred Marquardt	Paul Mendel	Andrew J. Pollmann	A.J. Pollmann	Elias Wipf	Samuel Z. Wipf	Samuel Z. Wipf	Joseph Glanzer	Michael Hofer	Michael Hofer	PG. Hofer	14	Joseph L. Hofer	J.M. Hofer
	12	Paul Mendel	Paul Mendel	Paul Mendel	John Hofer	Jacob Hofer	Peter Tschetter	Samuel Z. Wipf	Samuel Z. Wipf	Joseph Glanzer	Michael Hofer	Michael Hofer	PG. Hofer	15	Joseph L. Hofer	J.M. Hofer
CLAYTON	13	Jacob J. Pollmann	Joseph Pollmann	John Hofer	Paul W. Tschetter	Paul W. Tschetter	Paul W. Tschetter	Paul W. Tschetter	Paul W. Tschetter	Paul W. Tschetter	Paul W. Tschetter	Paul W. Tschetter	Paul W. Tschetter	16	Joseph L. Hofer	J.M. Hofer
	14	John Decombaz	Joshua Hofer Jr	School	Andrew C. Gross	Andrew C. Gross	Christ Hofman	Christ Hofman	Christ Hofman	Christ Hofman	Christ Hofman	Christ Hofman	Christ Hofman	17	Joseph L. Hofer	J.M. Hofer
	15	Chris. Roduner	Paul C. Gross	Jacob Walter Jr.	Andrew C. Gross	Andrew C. Gross	Joseph Walter	Joseph Walter	Joseph Walter	Joseph Walter	Joseph Walter	Joseph Walter	Joseph Walter	18	Joseph L. Hofer	J.M. Hofer
	16	Andrew Meitler	Fred Meyer	Jacob Walter Jr.	Geo. Roth	Geo. Roth	Joseph D. Tschetter	Joseph D. Tschetter	Joseph D. Tschetter	Joseph D. Tschetter	Joseph D. Tschetter	Joseph D. Tschetter	Joseph D. Tschetter	19	Joseph L. Hofer	J.M. Hofer
	17	John A. Meitler	Saml J. Wipf	J.A. Hofer	John A. Meitler	Saml J. Wipf	J.A. Hofer	John A. Meitler	Saml J. Wipf	J.A. Hofer	John A. Meitler	Saml J. Wipf	J.A. Hofer	20	Joseph L. Hofer	J.M. Hofer
	18	John A. Meitler	Saml J. Wipf	J.A. Hofer	John A. Meitler	Saml J. Wipf	J.A. Hofer	John A. Meitler	Saml J. Wipf	J.A. Hofer	John A. Meitler	Saml J. Wipf	J.A. Hofer	21	Joseph L. Hofer	J.M. Hofer
WOLF CREEK		EAST PART OF SILVER LAKE												PREC		

MAP OF
NORTH PART OF CLAYTON

Scale 1/4 inches to 1 mile

Fractional Township 100 North, Range 58 West of the 5th P.M.

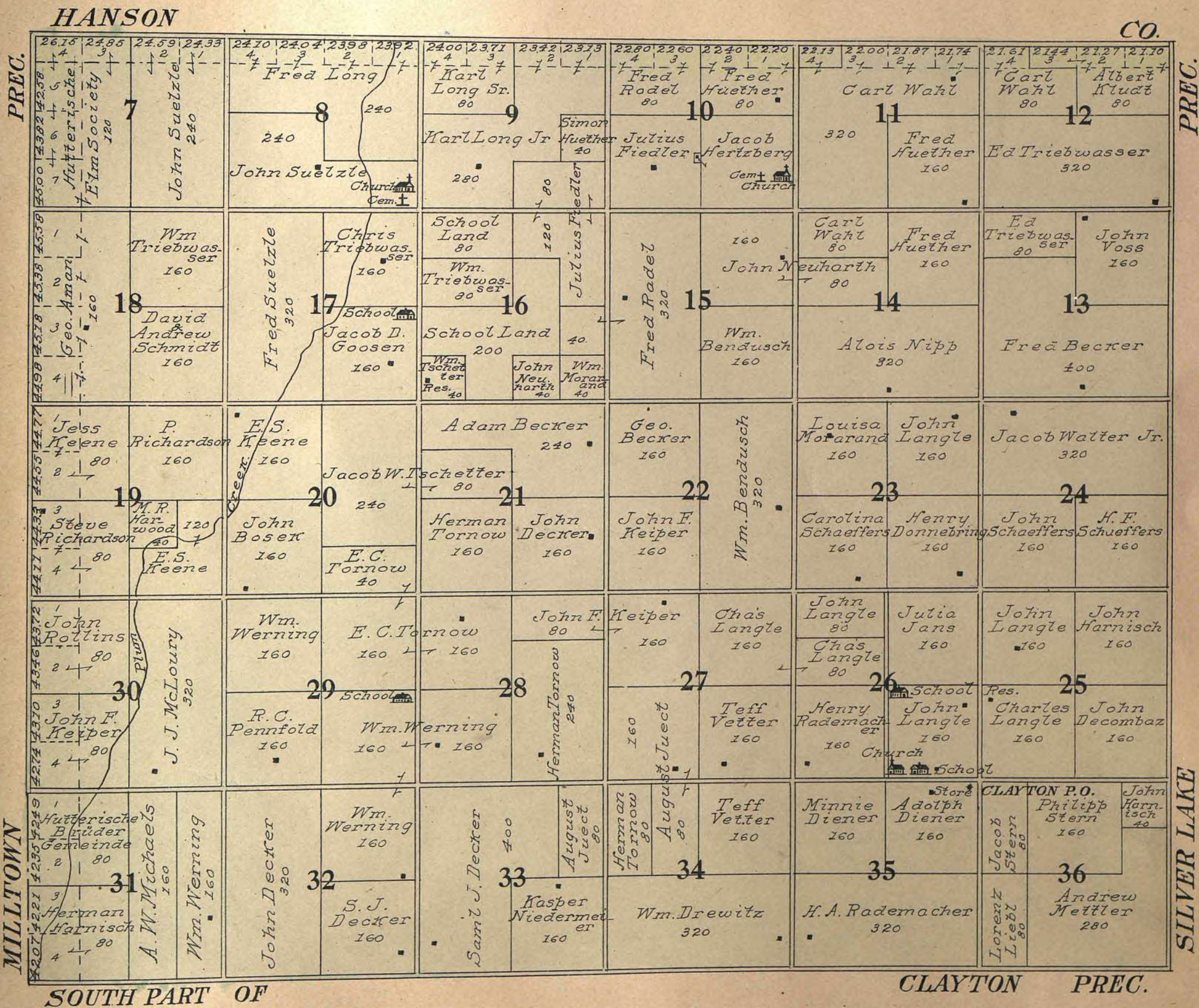

MAP OF NORTH PART OF MILLTOWN

Scale 1 1/4 inches to 1 mile

Fractional Township 100 North, Range 59 West of the 5th P.M.

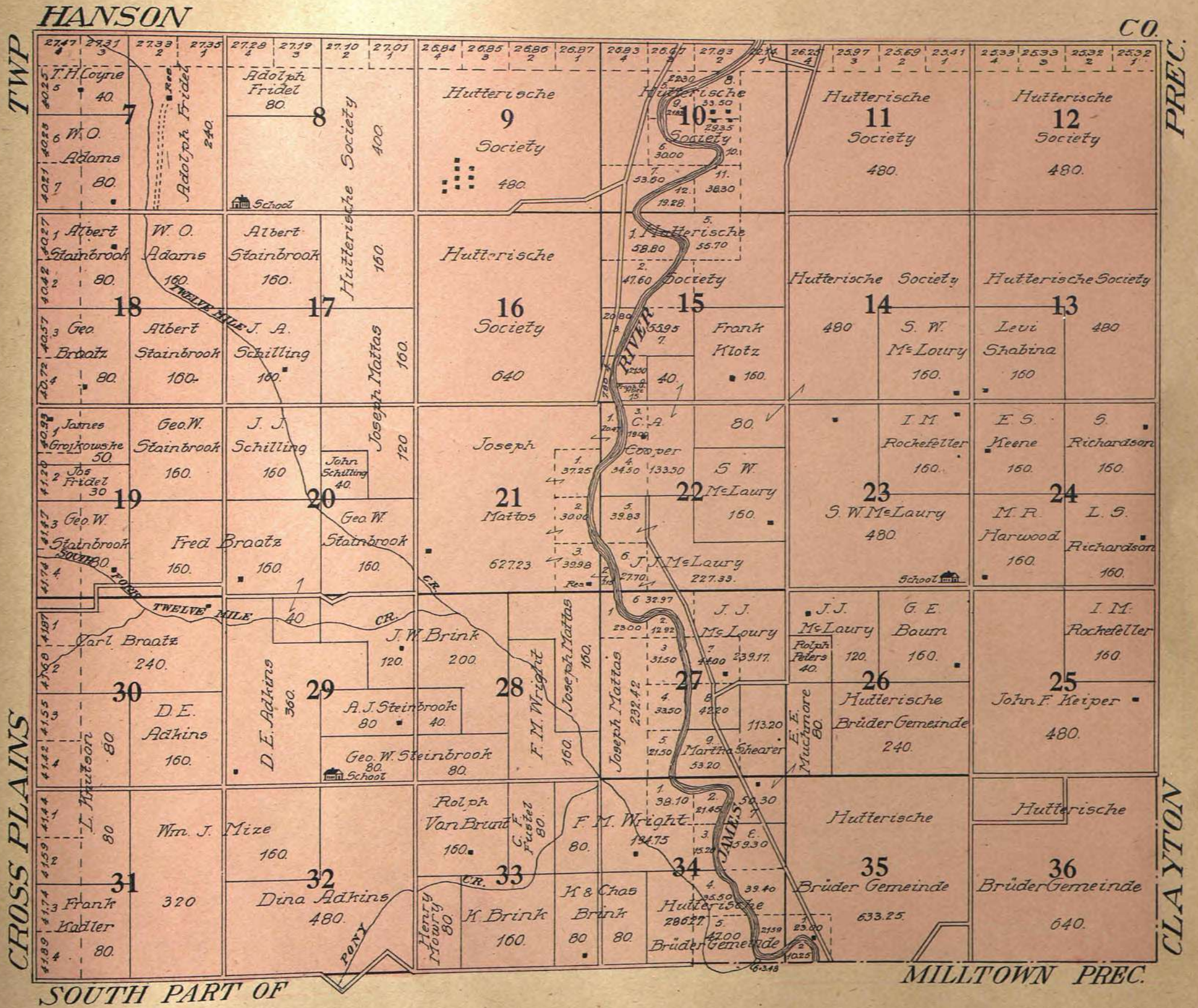

MAP OF CROSS PLAINS

Scale 1/4 inches to 1 mile

Fractional Township 100 North, Range 60 West of the 5th P.M.

DAVISON		CO. HANSON												CO.	
TWP.	2247 Hubert Weber	2262 Paul Schoenfelder	2279 Lona Schlingen	2296 Ferd Kurtenbach	2313 Peter Kurtenbach	2330 James F. Brink	2347 Jacob Brink	2364 W.H. Orther	2381 John Orther	2398 Wm.	2415 Adams	2432 Mich Coyne	2449 Hans J. Michelson	2466 H.F. Zehnpsennig	PREC.
	2284 Sigmund Weber	2301 Lona Schlingen	2318 Jos. Wermers	2335 Joseph J. Weber	2352 Lawrence Schlingen	2369 Phil. Kurtenbach	2386 Res. 160	2403 John Stainbrook	2420 W.H.	2437 Orther	2454 240	2471 160	2488 160	2505 160	
	2321 Engelbert Schlingen	2338 Lona Schlingen	2355 School	2372 Minnie Engels	2389 John H. Weber	2406 Peter Meyer	2423 Res. 400	2440 Hofatig Brink	2457 Jackson & Hurst	2474 Gottlieb Metzger	2491 160	2508 160	2525 Hans J. Michelson	2542 H.F. Zehnpsennig	
	2358 Frank Zehnpsennig	2375 Lona Schlingen	2392 Jos. Wermers	2409 Jos. Erlacher	2426 School Land	2443 John Reinsbach	2460 Karl Brecht	2477 Res. 160	2494 E. E. Sidnam	2511 Mrs. Reynolds	2528 160	2545 160	2562 Hans J. Michelson	2579 160	
	2395 Matthew Bohr	2412 Jos. Wermers	2429 Frank Zehnpsennig	2446 Matthew Behrendt Sr.	2463 Pleasant View Farm E. M. Untereiner	2480 Jos. Geidel	2497 Karl Brecht	2514 Res. 240	2531 E. E. Sidnam	2548 Joseph Fridel	2565 160	2582 160	2599 160	2616 160	
	2432 Frank Bohr	2449 Jos. Wermers	2466 James Maher	2483 Karl Mechtenberg	2500 Matthew Germisheid	2517 Herman Mechtenberg	2534 Res. 240	2551 Jacob Geisen	2568 Kate Jacobson	2585 Chas Cox	2602 160	2619 160	2636 160	2653 160	
	2469 Matthew Roth	2486 Nick Fisch	2503 Wm Kabisemann	2520 David Evans	2537 Thomas Evans	2554 Peter Brech	2571 Evergreen Stock Farm Jacob Giesen	2588 Res. 160	2605 C.M. Bailes	2622 Mary Wanderwitten	2639 160	2656 160	2673 160	2690 160	
	2506 Frank Fischer	2523 John Meiser	2540 A.H. Wright	2557 Frank Schacher	2574 Schurz	2591 Peter Arnsberg	2608 John G. Weber	2625 Jacob Giesen	2642 O.T. McClain	2659 O.T. McClain	2676 Chris Thompson	2693 160	2710 160	2727 160	
	2543 Nick Meyer	2560 Paul Schoenfelder	2577 H. B. Faust	2594 Peter	2611 Matthew Germisheid	2628 Ole or Harris Melroy	2645 John Frytza	2662 Res. 480	2679 O.T. McClain	2696 School Land	2713 36	2730 640	2747 160	2764 160	
	2580 Peter Puetz	2597 H. B. Faust	2614 Henry Degen	2631 John Wahl Est.	2648 Chas Nickel	2665 Jas McClain	2682 J.G. Belknap	2699 Res.	2716 Joseph Lingscheit	2733 35	2750 36	2767 160	2784 160	2801 160	
2617 STARR	2634 LIBERTY	2651 TWP.	2668 TWP.	2685 TWP.	2702 TWP.	2719 TWP.	2736 TWP.	2753 TWP.	2770 TWP.	2787 TWP.	2804 TWP.	2821 TWP.	2838 TWP.	2855 MILL TOWN	

MAP OF
STARR

Scale 1 1/4 inches to 1 mile

Fractional Township 100 North, Range 61 West of the 5th P.M.

	DAVISON																							
	CO.																							
	2529 1 4 5 6 7 8 9 10 11 12 13 14 15 16 17 18 19 20 21 22 23 24 25 26 27 28 29 30 31 32 33 34 35 36	2969 1 2 3 4 5 6 7 8 9 10 11 12 13 14 15 16 17 18 19 20 21 22 23 24 25 26 27 28 29 30 31 32 33 34 35 36	2975 1 2 3 4 5 6 7 8 9 10 11 12 13 14 15 16 17 18 19 20 21 22 23 24 25 26 27 28 29 30 31 32 33 34 35 36	2987 1 2 3 4 5 6 7 8 9 10 11 12 13 14 15 16 17 18 19 20 21 22 23 24 25 26 27 28 29 30 31 32 33 34 35 36	2999 1 2 3 4 5 6 7 8 9 10 11 12 13 14 15 16 17 18 19 20 21 22 23 24 25 26 27 28 29 30 31 32 33 34 35 36	2998 1 2 3 4 5 6 7 8 9 10 11 12 13 14 15 16 17 18 19 20 21 22 23 24 25 26 27 28 29 30 31 32 33 34 35 36	2997 1 2 3 4 5 6 7 8 9 10 11 12 13 14 15 16 17 18 19 20 21 22 23 24 25 26 27 28 29 30 31 32 33 34 35 36	2996 1 2 3 4 5 6 7 8 9 10 11 12 13 14 15 16 17 18 19 20 21 22 23 24 25 26 27 28 29 30 31 32 33 34 35 36	2970 1 2 3 4 5 6 7 8 9 10 11 12 13 14 15 16 17 18 19 20 21 22 23 24 25 26 27 28 29 30 31 32 33 34 35 36	2960 1 2 3 4 5 6 7 8 9 10 11 12 13 14 15 16 17 18 19 20 21 22 23 24 25 26 27 28 29 30 31 32 33 34 35 36	2950 1 2 3 4 5 6 7 8 9 10 11 12 13 14 15 16 17 18 19 20 21 22 23 24 25 26 27 28 29 30 31 32 33 34 35 36	2940 1 2 3 4 5 6 7 8 9 10 11 12 13 14 15 16 17 18 19 20 21 22 23 24 25 26 27 28 29 30 31 32 33 34 35 36	2935 1 2 3 4 5 6 7 8 9 10 11 12 13 14 15 16 17 18 19 20 21 22 23 24 25 26 27 28 29 30 31 32 33 34 35 36	2917 1 2 3 4 5 6 7 8 9 10 11 12 13 14 15 16 17 18 19 20 21 22 23 24 25 26 27 28 29 30 31 32 33 34 35 36	2899 1 2 3 4 5 6 7 8 9 10 11 12 13 14 15 16 17 18 19 20 21 22 23 24 25 26 27 28 29 30 31 32 33 34 35 36	2887 1 2 3 4 5 6 7 8 9 10 11 12 13 14 15 16 17 18 19 20 21 22 23 24 25 26 27 28 29 30 31 32 33 34 35 36	2864 1 2 3 4 5 6 7 8 9 10 11 12 13 14 15 16 17 18 19 20 21 22 23 24 25 26 27 28 29 30 31 32 33 34 35 36	2858 1 2 3 4 5 6 7 8 9 10 11 12 13 14 15 16 17 18 19 20 21 22 23 24 25 26 27 28 29 30 31 32 33 34 35 36	2852 1 2 3 4 5 6 7 8 9 10 11 12 13 14 15 16 17 18 19 20 21 22 23 24 25 26 27 28 29 30 31 32 33 34 35 36	2846 1 2 3 4 5 6 7 8 9 10 11 12 13 14 15 16 17 18 19 20 21 22 23 24 25 26 27 28 29 30 31 32 33 34 35 36	2864 1 2 3 4 5 6 7 8 9 10 11 12 13 14 15 16 17 18 19 20 21 22 23 24 25 26 27 28 29 30 31 32 33 34 35 36	2860 1 2 3 4 5 6 7 8 9 10 11 12 13 14 15 16 17 18 19 20 21 22 23 24 25 26 27 28 29 30 31 32 33 34 35 36	2856 1 2 3 4 5 6 7 8 9 10 11 12 13 14 15 16 17 18 19 20 21 22 23 24 25 26 27 28 29 30 31 32 33 34 35 36	2852 1 2 3 4 5 6 7 8 9 10 11 12 13 14 15 16 17 18 19 20 21 22 23 24 25 26 27 28 29 30 31 32 33 34 35 36
	TWP.																							
	CO.																							
	DOUGLAS																							
	SUSQUEHANNA																							
	TWP.																							
	CROSS PLAINS																							